



Northsea Shipyard Ltd.

**Electrical drawings
for yard no. 221
Section 11-31**

El-dept.

W.Meinertz Olesen & Co. Ltd.

Tel: 045-97-323800

extern.

← Plc broolen

← Plc Maskin alan

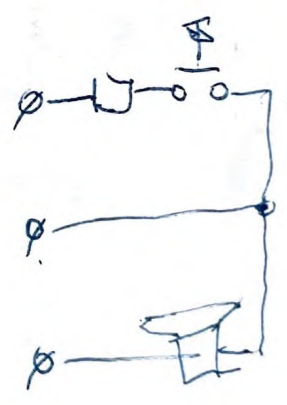
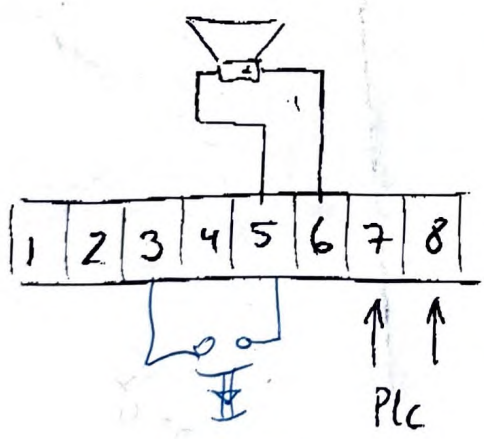
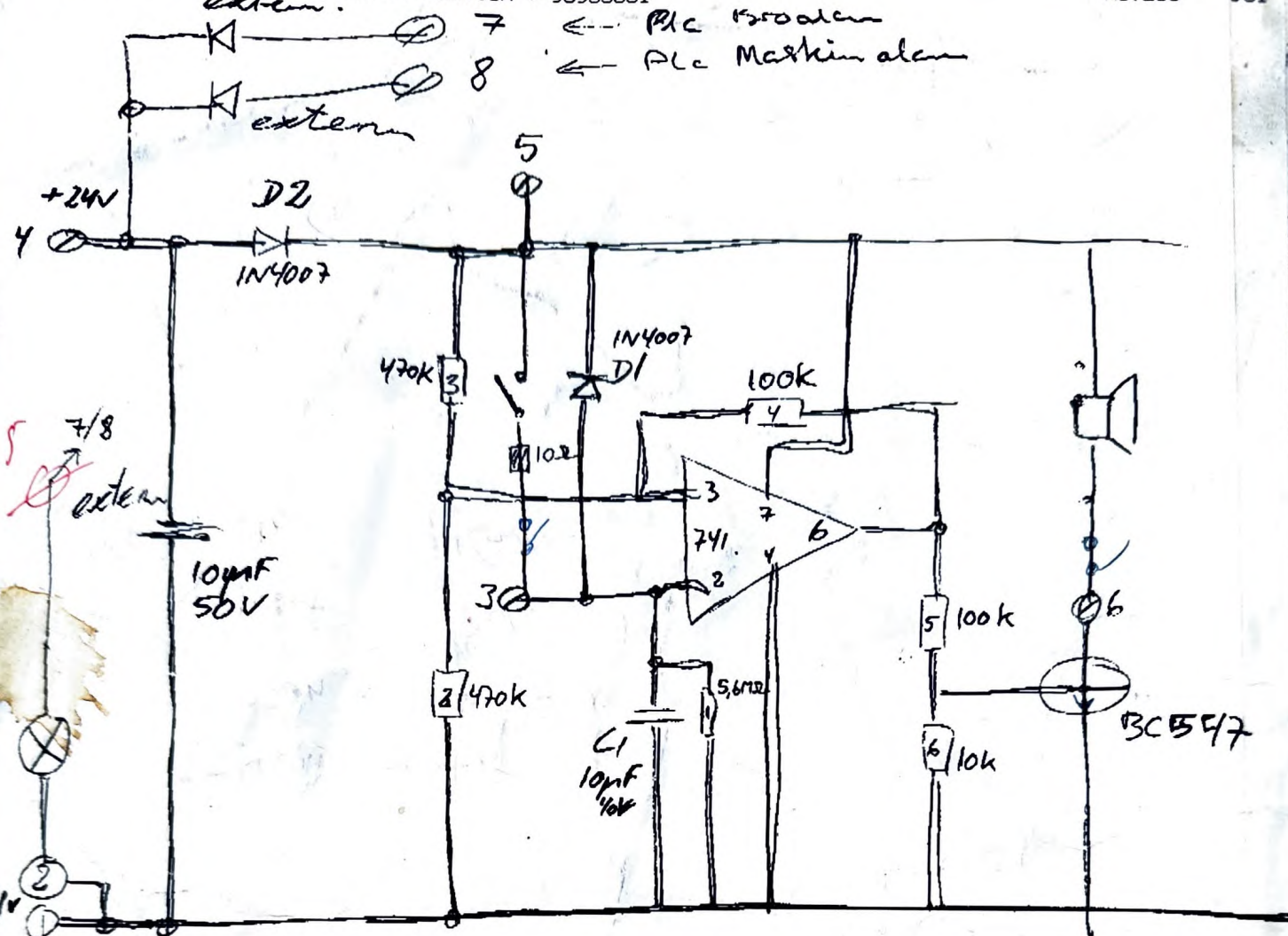

WMO 0701-182-1

VAGT ALARM.

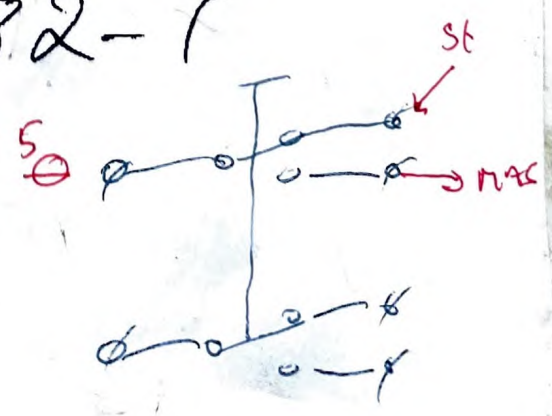

1	Startbox for Aux:1-4	No 1A/1B/1C/1D
2	Connection-box for Bowthruster 1+2	No 1E
3	Ballast-switchboard	No 1F
4	Connection-box for PS-propulsion	No 1G
5	Connection-box for SB-propulsion	No 1H
6	Start/Stop PS-eng.-room	No 1I
7	Start/Stop SB-eng.-room	No 1J
8	Temp.-sensor Sterntube	No 1K
9	Main switchboard	No 2A
10	220/380VAC Switchboard	No 2B
11	Controldesk Control-room	No 2C
12	Connection-box for Sternthruster 1+2	No 2D
13	Workingair compressor	No 2E
14	Steeringgear 1PS	No 2F
15	Steeringgear 2PS	No 2G
16	Steeringgear 1SB	No 2H
17	Steeringgear 2SB	No 2I
18	Shoreconnection-switchboard	No 2J
19	Emergency-switchboard	No 2K
20	Hydraulic-unit Foc'le	No 2L
21	Control-unit Hydraulic	No 2M
22	Gyro-repeater Steeringgear-room	No 2N
23	Nav.-light switchboard etc.	Bridge No 5A
24	24VDC Charger	Bridge No 5B
25	Radio Charger	Bridge No 5C
26	Controlpanel for Hydraulic-unit	Bridge No 5D
27	Controlpanel PS-desk	Bridge No 5E
28	Steeringgearpanel etc.	Bridge No 5F
29	Propulsion/Thruster-panel	Bridge No 5G
30	Communal aerial	No 5H
31	Terminals description	

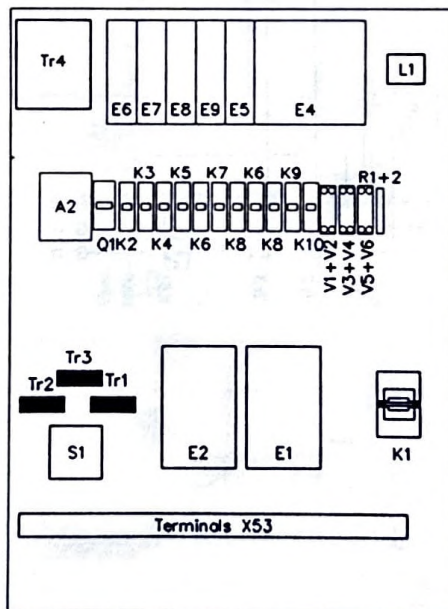
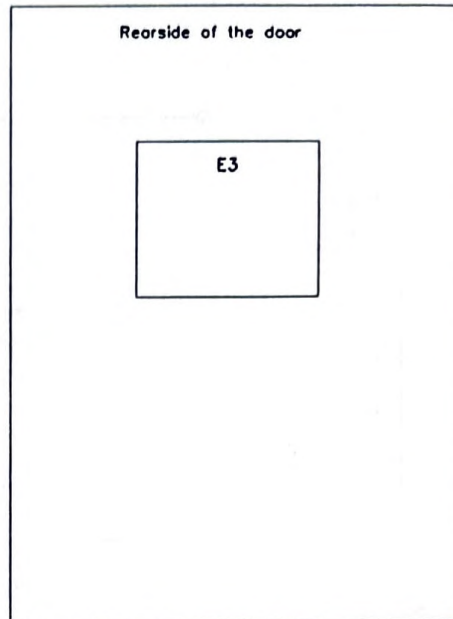
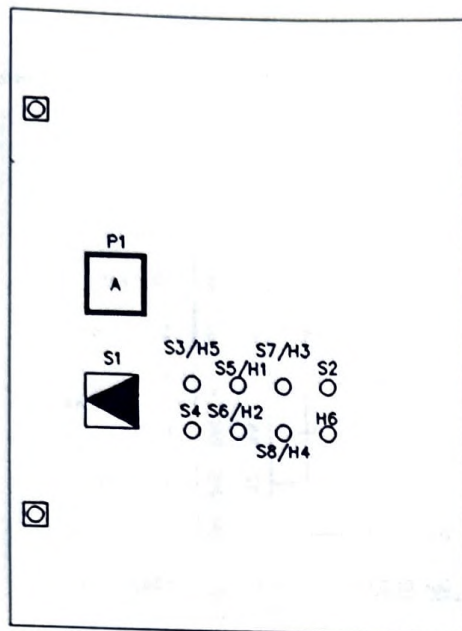

	North Sea Shipyard Ltd. DK-6950 Ringkøbing Denmark Phone +45 97 32 38 00	Apellation	Yard No.	Unit No.	Section No.	Side No.
		Steeringgear 1 PS (Terminals X53)	221	2F		A
W/MO	W.Meinertz Olesen & Co. A/S	Phone +45-97-323800		Date:	1-6-1994	

Emergency switchboard
 F6 S.2K-C3D
 3x6mm MGG 1000V

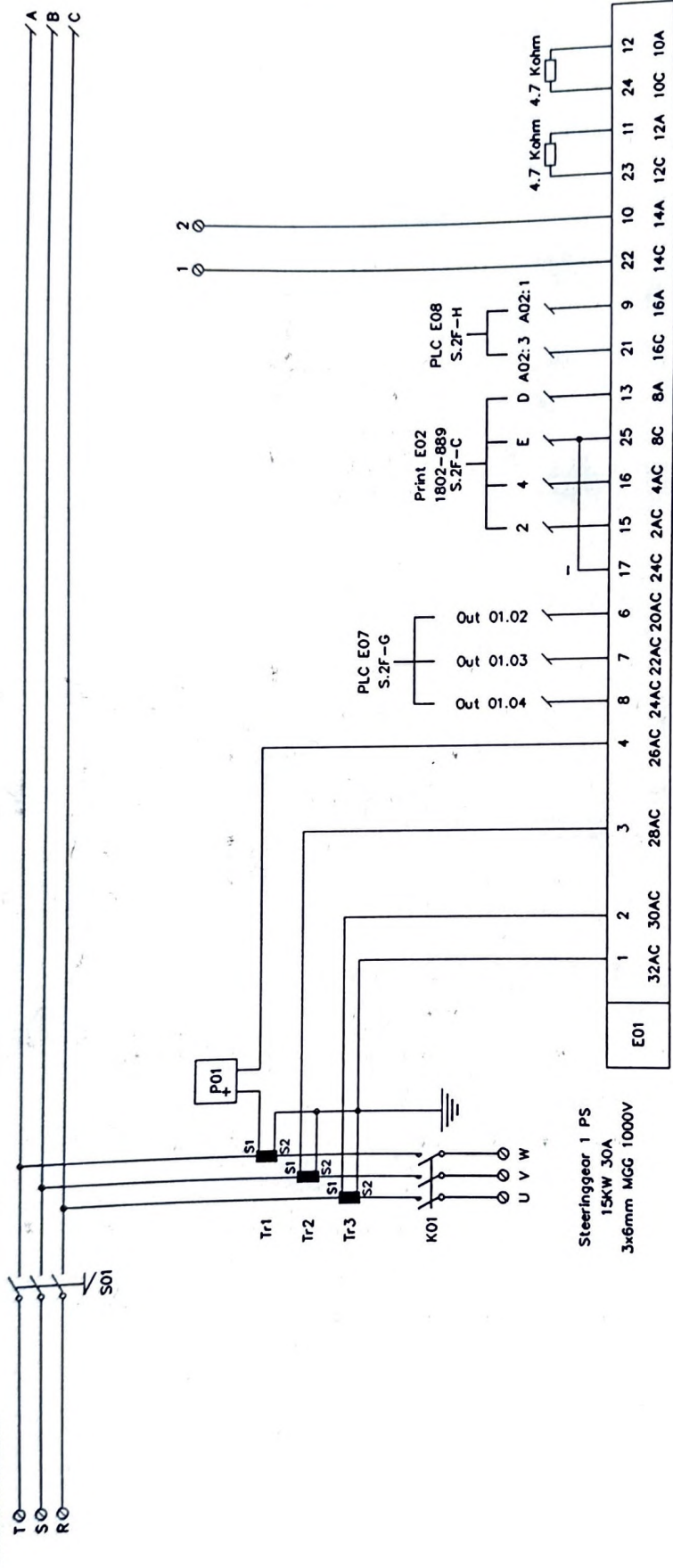

Steeringgear 1 PS
 15KW 30A
 3x6mm MGG 1000V

Multiplexer

	North Sea Shipyard Ltd. DK-6950 Ringkoebing Denmark Phone +45 97 32 38 00	Appellation	Yard No.	Unit No.	Section No.	Side No.
	Steeringgear 1 PS (Terminals X53)		221	2F		B
WMO	W.Meinertz Olesen & Co. A/S	Phone +45-97-323800	Date:	1-6-1994		

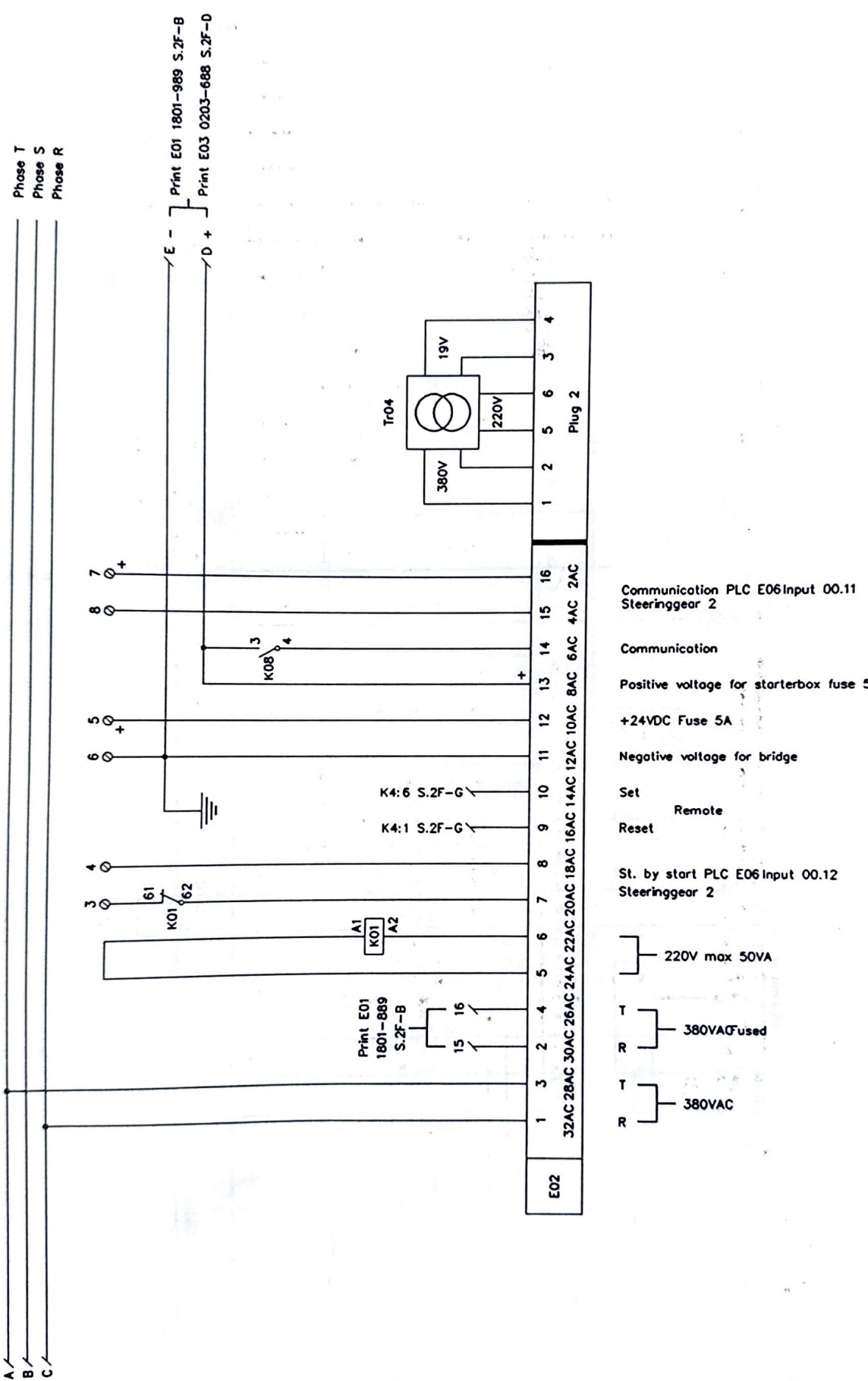

	North Sea Shipyard Ltd. DK-6950 Ringkøbing Denmark Phone +45 97 32 38 00	Apellation	Yard No.	Unit No.	Section No.	Side No.
	W/MO	W.Meinertz Olesen & Co. A/S	Steeringgear 1 PS (Terminals X53)	221	2F	C
			Phone +45-97-323800	Date:	2-5-1994	

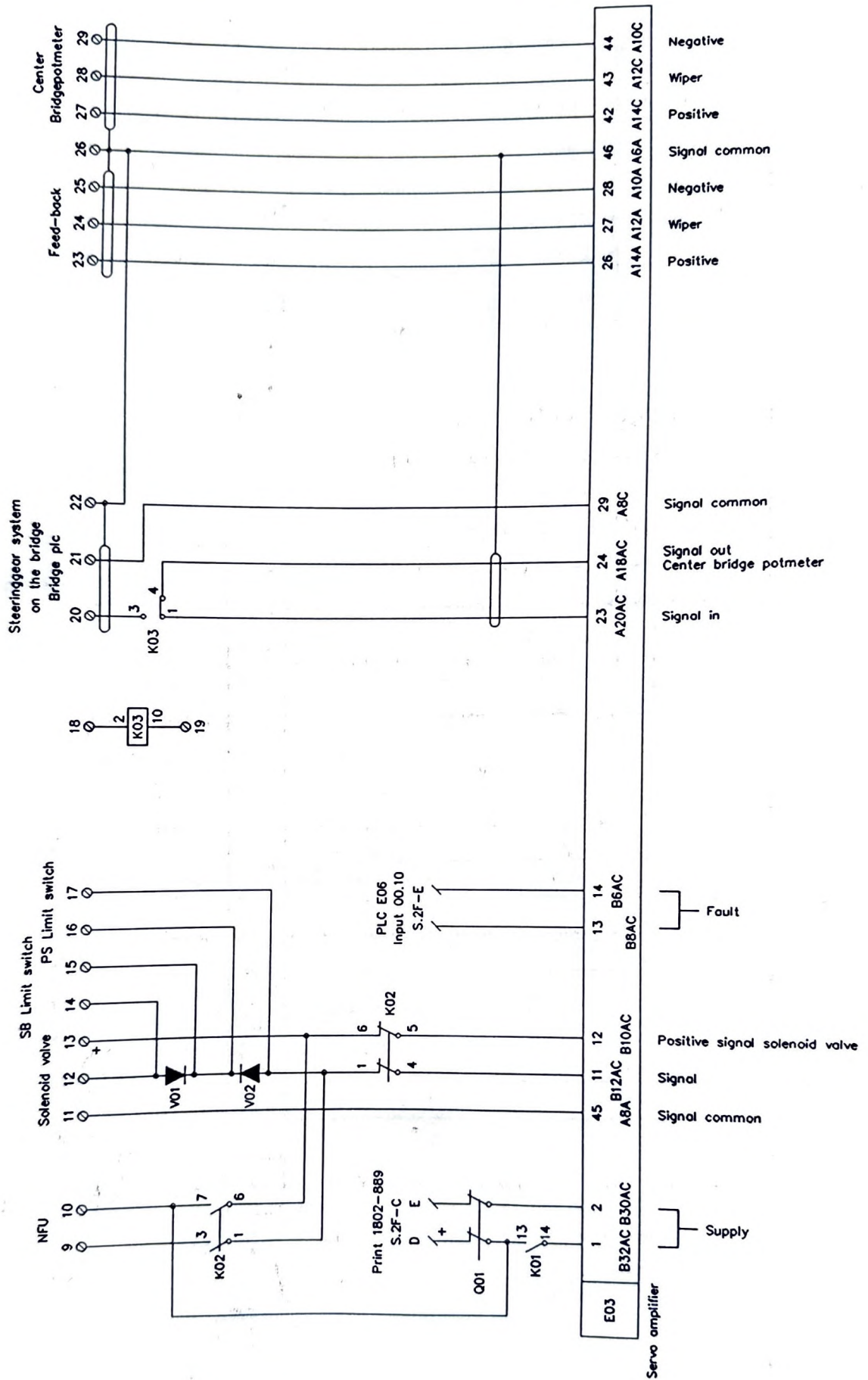

North Sea Shipyard Ltd.
 DK-6950 Ringkøbing Denmark
 Phone +45 97 32 38 00

Appellation
 Steeringgear 1 PS (Terminals X53)

Yard No.	Unit No.	Section No.	Side No.
221	2F		D

WMO

W.Meinertz Olesen & Co. A/S

Phone +45-97-323800

Date: 2-5-1994

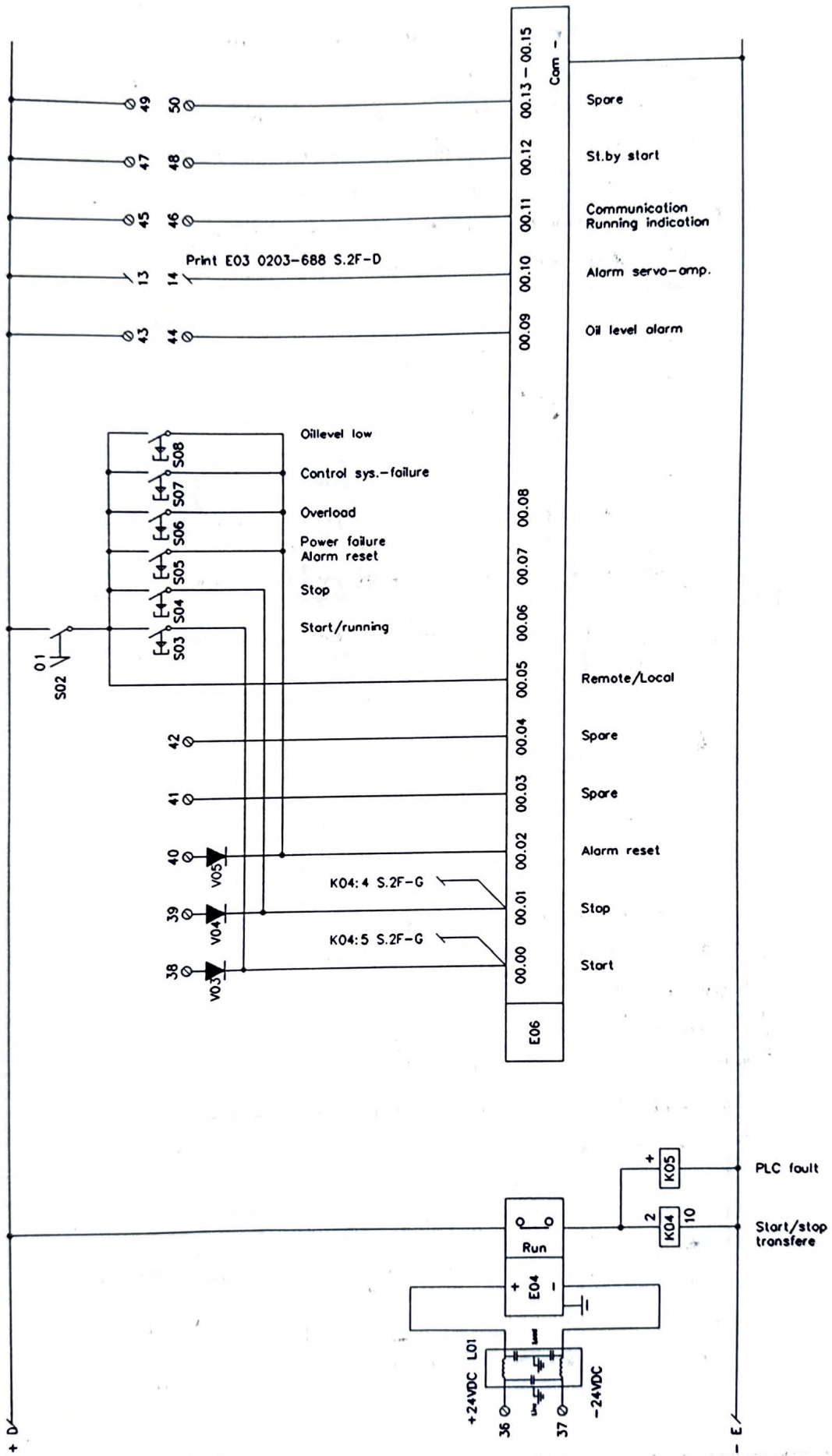

North Sea Shipyard Ltd.
 DK-6950 Ringkøbing Denmark
 Phone +45 97 32 38 00

Apellation
 Steeringgear 1 PS (Terminals X53)

Yard No.	Unit No.	Section No.	Side No.
221	2F		E

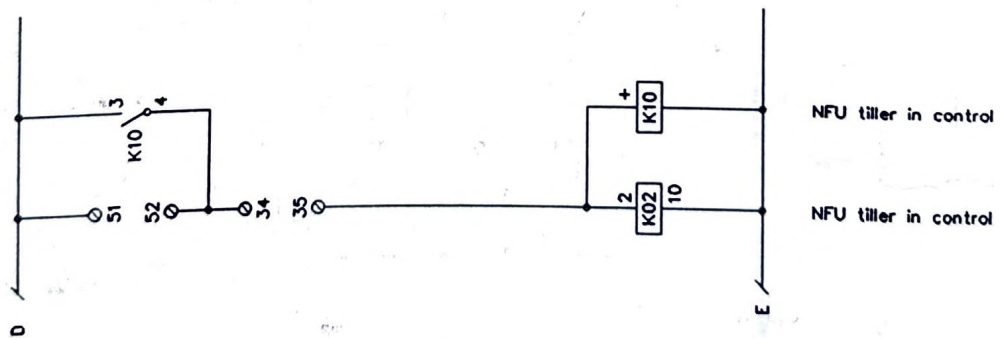

North Sea Shipyard Ltd.
 DK-6950 Ringkøbing Denmark
 Phone +45 97 32 38 00

Appellation
 Steeringgear 1 PS (Terminals X53)

Yard No.	Unit No.	Section No.	Side No.
221	2F		F

W/MO

W.Meinertz Olesen & Co. A/S

Phone +45-97-323800

Date: 29-3-1994

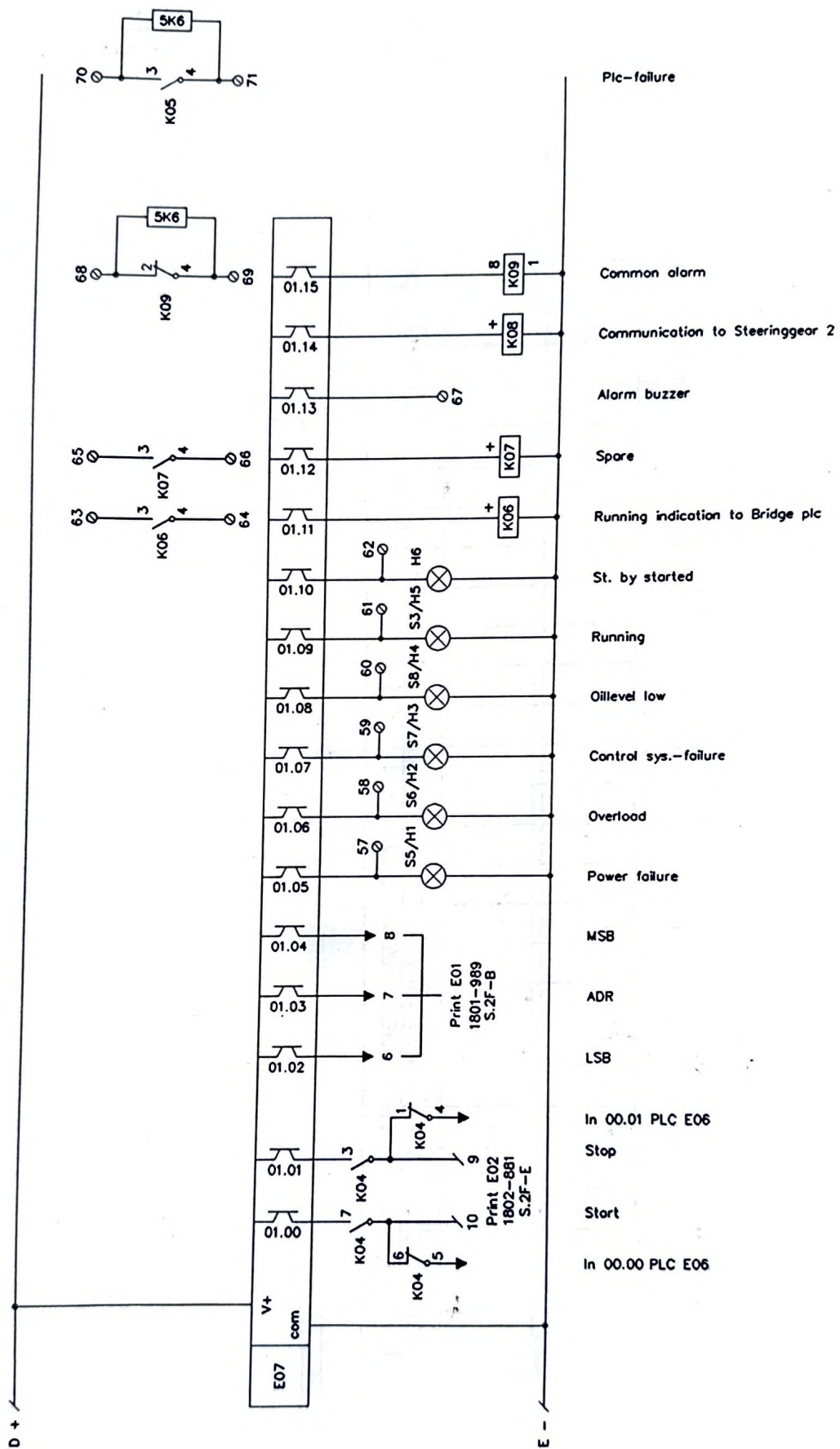

- Plc-failure
- Common alarm
- Communication to Steeringgear 2
- Alarm buzzer
- Spare
- Running indication to Bridge plc
- St. by started
- Running
- Oillevel low
- Control sys.-failure
- Overload
- Power failure
- MSB
- ADR
- LSB
- In 00.01 PLC E06
- Stop
- Start
- In 00.00 PLC E06



North Sea Shipyard Ltd.
 DK-6950 Ringkøbing Denmark
 Phone +45 97 32 38 00

Apellation

Steeringgear 1 PS (Terminals X53)

Yard No.

221

Unit No.

2F

Section No.

Side No.

G

W/MO

W.Meinertz Olesen & Co. A/S

Phone +45-97-323800

Date: 2-5-1994

Print E01
S.2F_B

9
21

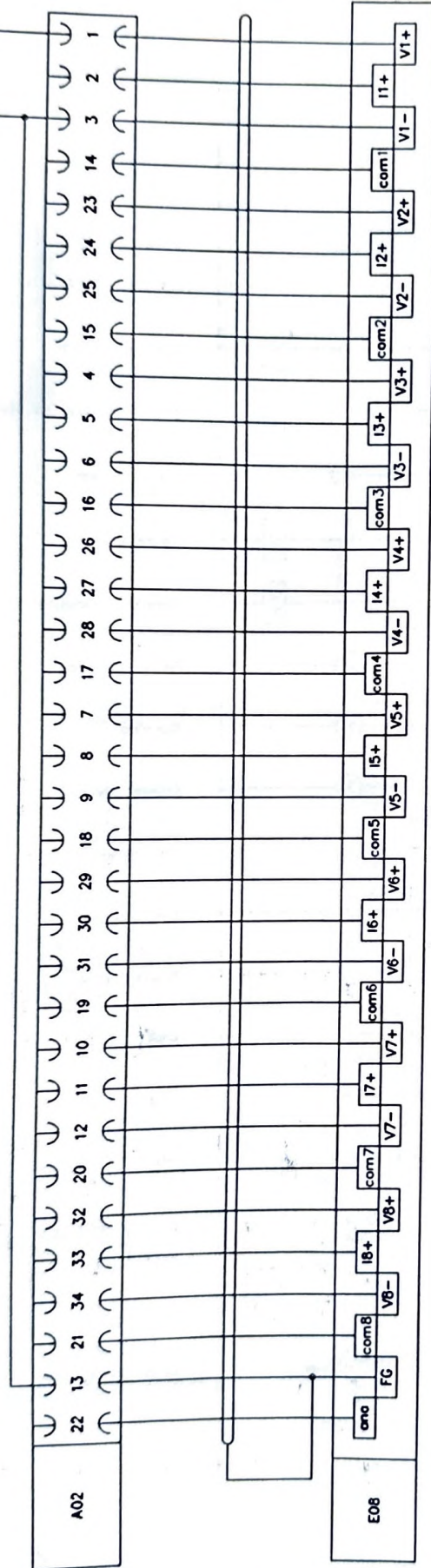

Multiplexed analog input signal
of current, internal voltage,
external voltage and oil temperature.

Unit no: 0



North Sea Shipyard Ltd.
DK-6950 Ringkøbing Denmark
Phone +45 97 32 38 00

Appellation

Steeringgear 1 PS (Terminals X53)

Yard No.

221

Unit No.

2F

Section No.

Side No.

H

WMO

W.Meinertz Olesen & Co. A/S

Phone +45-97-323800

Date:

2-5-1994

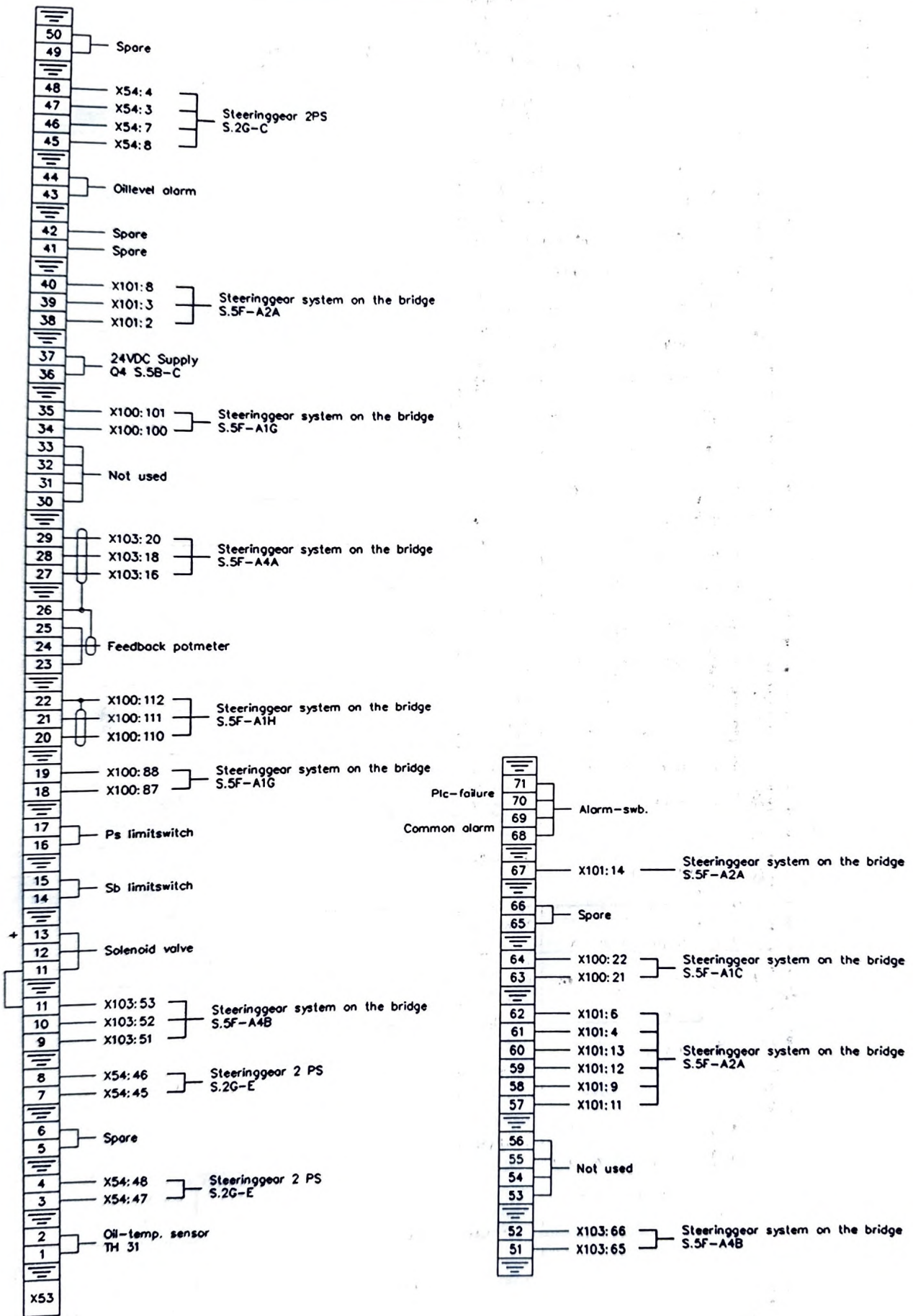

North Sea Shipyard Ltd.
 DK-6950 Ringkøbing Denmark
 Phone +45 97 32 38 00

Appellation

Steeringgear 1 PS (Terminals X53)

Yard No.
221

Unit No.
2F

Section No.

Side No.
1

W/MO

W.Meinertz Olesen & Co. A/S

Phone +45-97-323800

Date: 3-6-1994

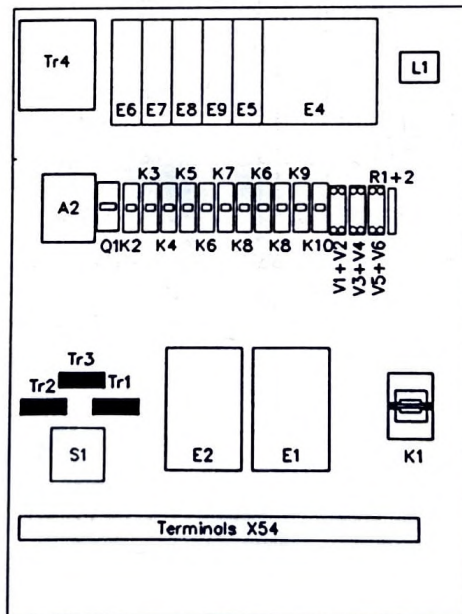
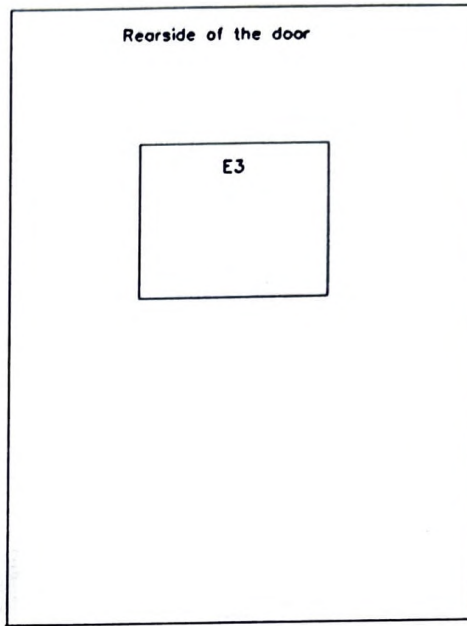
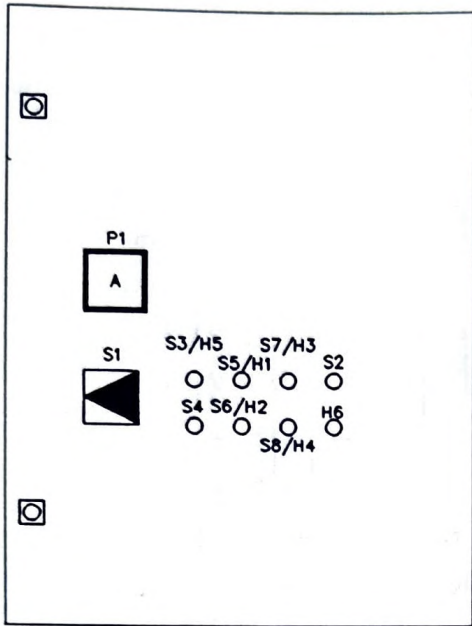

	North Sea Shipyard Ltd. DK-6950 Ringkøbing Denmark Phone +45 97 32 38 00	Apellation	Yard No.	Unit No.	Section No.	Side No.
		Steeringgear 2 PS (Terminals X54)	221	2G		A
W/MO	W.Meinertz Olesen & Co. A/S	Phone +45-97-323800	Date:	1-6-1994		

220/380V switchboard
 F5 S.2B-C1A
 3x6mm MGG 1000V

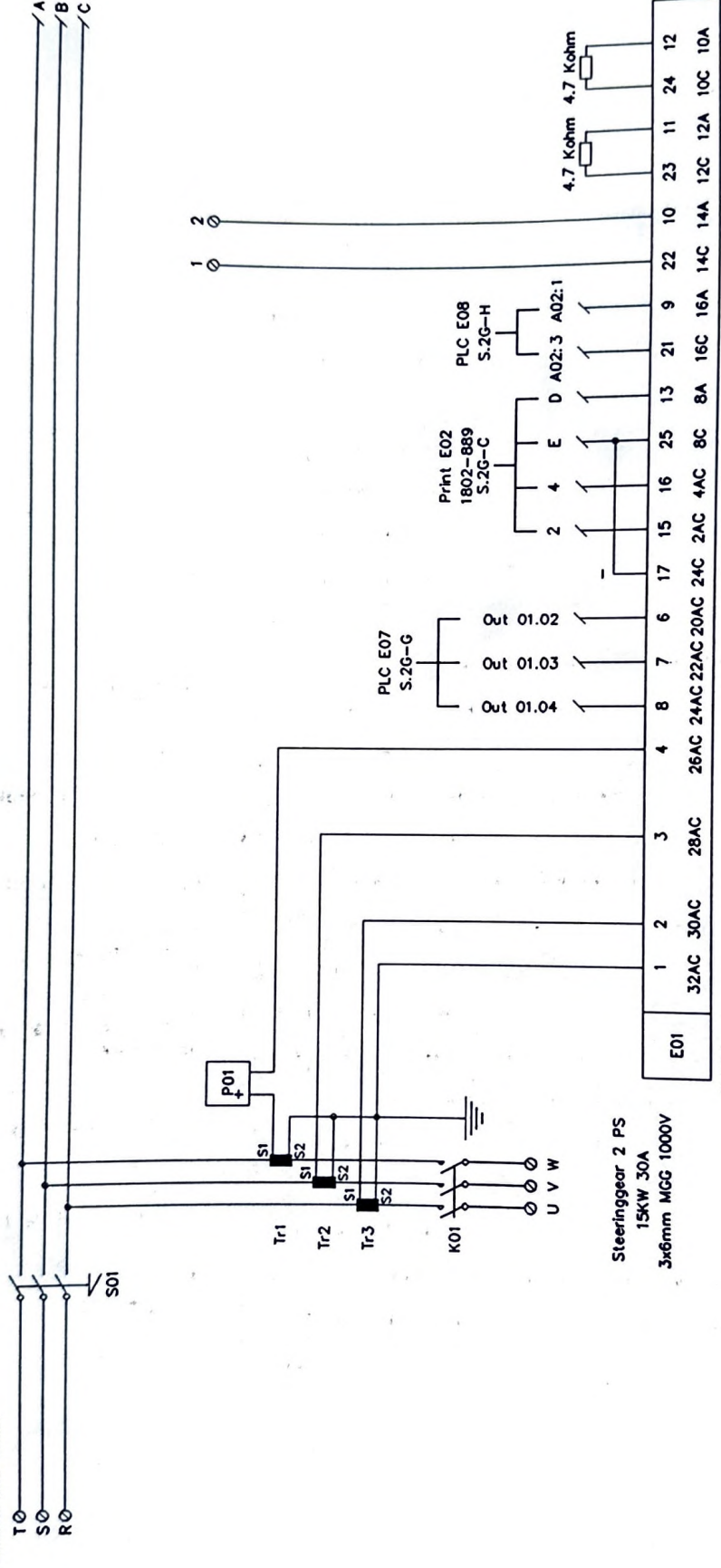

1 2 3 4 6 7 8 17 15 16 25 13 21 9 22 10 23 11 24 12

32AC 30AC 28AC 26AC 24AC 22AC 20AC 24C 2AC 4AC 8C 8A 16C 16A 12C 12A 10C 10A

Steeringgear 2 PS
 15KW 30A
 3x6mm MGG 1000V

Multiplexer

1 com
 2
 3
 4
 6
 7
 8
 17
 15
 16
 25
 13
 21
 9
 22
 10
 23
 11
 24
 12

MSB
 ADR
 LSB
 ADR com
 T
 R
 380V
 Signal com
 24V ext.
 com
 Out signal
 com
 TH 31 temp.-sensor

	North Sea Shipyard Ltd. DK-6950 Ringkoebling Denmark Phone +45 97 32 38 00	Appellation			
		Steeringgear 2 PS (Terminals X54)			
WMO	W.Meinertz Olesen & Co. A/S	Yard No.	Unit No.	Section No.	Side No.
		221	2G		B
Phone +45-97-323800				Date: 12-6-1994	

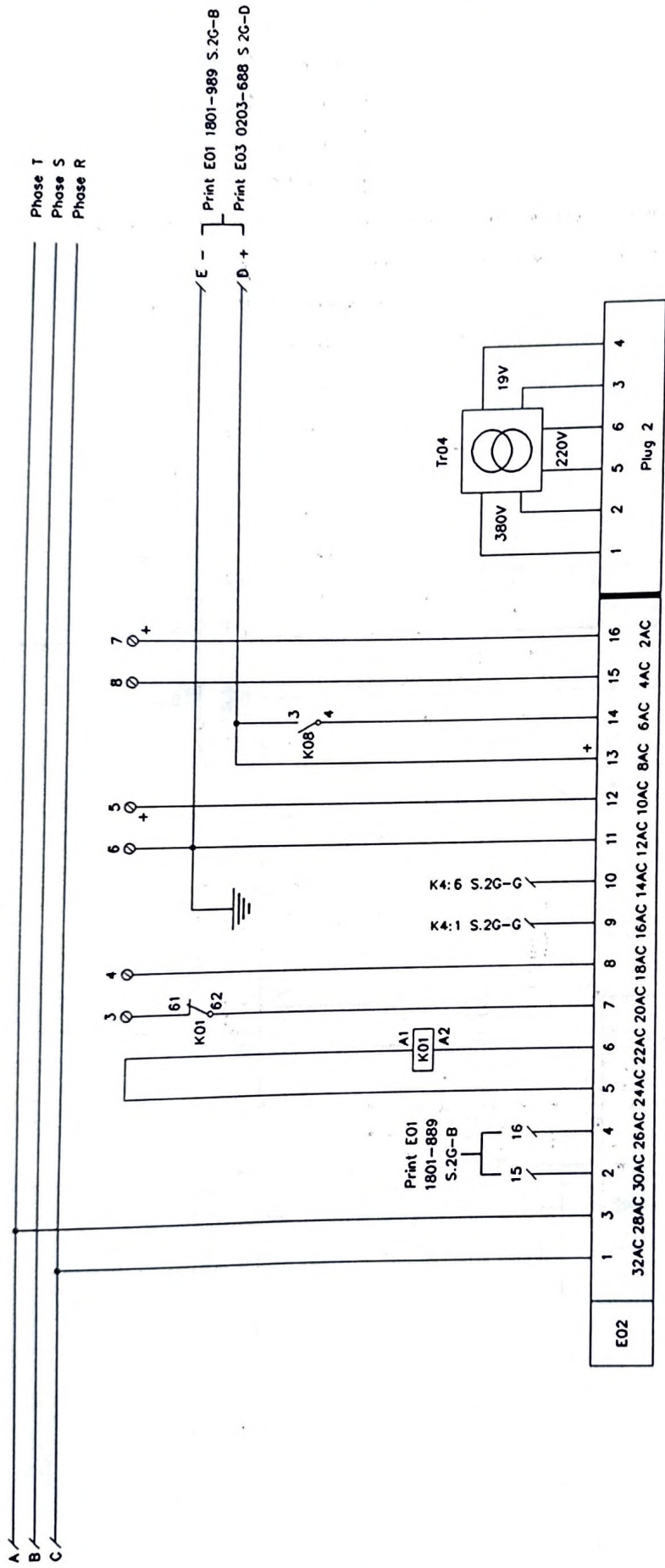

- 1 2AC 28AC 30AC 26AC 24AC 22AC 20AC 18AC 16AC 14AC 12AC 10AC 8AC 6AC 4AC 2AC
 - 2 32AC 28AC 30AC 26AC 24AC 22AC 20AC 18AC 16AC 14AC 12AC 10AC 8AC 6AC 4AC 2AC
 - 3 32AC 28AC 30AC 26AC 24AC 22AC 20AC 18AC 16AC 14AC 12AC 10AC 8AC 6AC 4AC 2AC
 - 4 32AC 28AC 30AC 26AC 24AC 22AC 20AC 18AC 16AC 14AC 12AC 10AC 8AC 6AC 4AC 2AC
 - 5 32AC 28AC 30AC 26AC 24AC 22AC 20AC 18AC 16AC 14AC 12AC 10AC 8AC 6AC 4AC 2AC
 - 6 32AC 28AC 30AC 26AC 24AC 22AC 20AC 18AC 16AC 14AC 12AC 10AC 8AC 6AC 4AC 2AC
 - 7 32AC 28AC 30AC 26AC 24AC 22AC 20AC 18AC 16AC 14AC 12AC 10AC 8AC 6AC 4AC 2AC
 - 8 32AC 28AC 30AC 26AC 24AC 22AC 20AC 18AC 16AC 14AC 12AC 10AC 8AC 6AC 4AC 2AC
 - 9 32AC 28AC 30AC 26AC 24AC 22AC 20AC 18AC 16AC 14AC 12AC 10AC 8AC 6AC 4AC 2AC
 - 10 32AC 28AC 30AC 26AC 24AC 22AC 20AC 18AC 16AC 14AC 12AC 10AC 8AC 6AC 4AC 2AC
 - 11 32AC 28AC 30AC 26AC 24AC 22AC 20AC 18AC 16AC 14AC 12AC 10AC 8AC 6AC 4AC 2AC
 - 12 32AC 28AC 30AC 26AC 24AC 22AC 20AC 18AC 16AC 14AC 12AC 10AC 8AC 6AC 4AC 2AC
 - 13 32AC 28AC 30AC 26AC 24AC 22AC 20AC 18AC 16AC 14AC 12AC 10AC 8AC 6AC 4AC 2AC
 - 14 32AC 28AC 30AC 26AC 24AC 22AC 20AC 18AC 16AC 14AC 12AC 10AC 8AC 6AC 4AC 2AC
 - 15 32AC 28AC 30AC 26AC 24AC 22AC 20AC 18AC 16AC 14AC 12AC 10AC 8AC 6AC 4AC 2AC
 - 16 32AC 28AC 30AC 26AC 24AC 22AC 20AC 18AC 16AC 14AC 12AC 10AC 8AC 6AC 4AC 2AC
- Communication PLC E06 Input 00.11 Steeringgear 1
 Communication
 Positive voltage for starterbox fuse 5A
 +24VDC Fuse 5A
 Negative voltage for bridge
 Set Remote
 Reset
 St. by start PLC E06 Input 00.12 Steeringgear 1
- [] 220V max 50VA
 T [] 380VAC Fused
 R [] 380VAC

	North Sea Shipyard Ltd. DK-6950 Ringkoebing Denmark Phone +45 97 32 38 00	Apellation Steeringgear 2 PS (Terminals X54)	Yard No. 221	Unit No. 2G	Section No.	Side No. C
	W/MC W.Meinertz Olesen & Co. A/S	Phone +45-97-323800	Date:	3-6-1994		

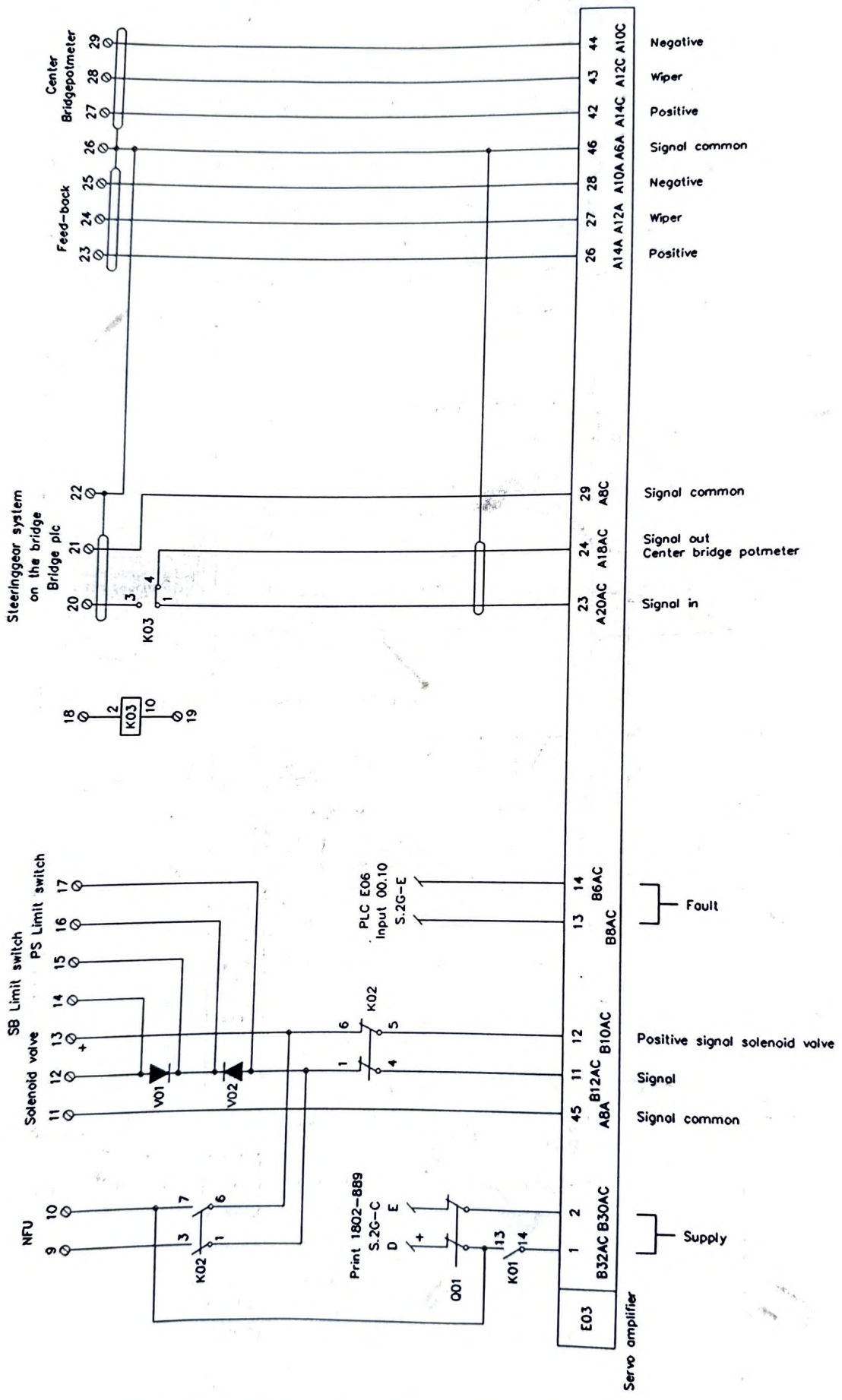

North Sea Shipyard Ltd.
 DK-6950 Ringkoebing Denmark
 Phone +45 97 32 38 00

Apellation
 Steeringgear 2 PS (Terminals X54)

Yard No.	Unit No.	Section No.	Side No.
221	2G		0

W/MO

W.Meinertz Olesen & Co. A/S

Phone +45-97-323800

Date: 3-6-1994

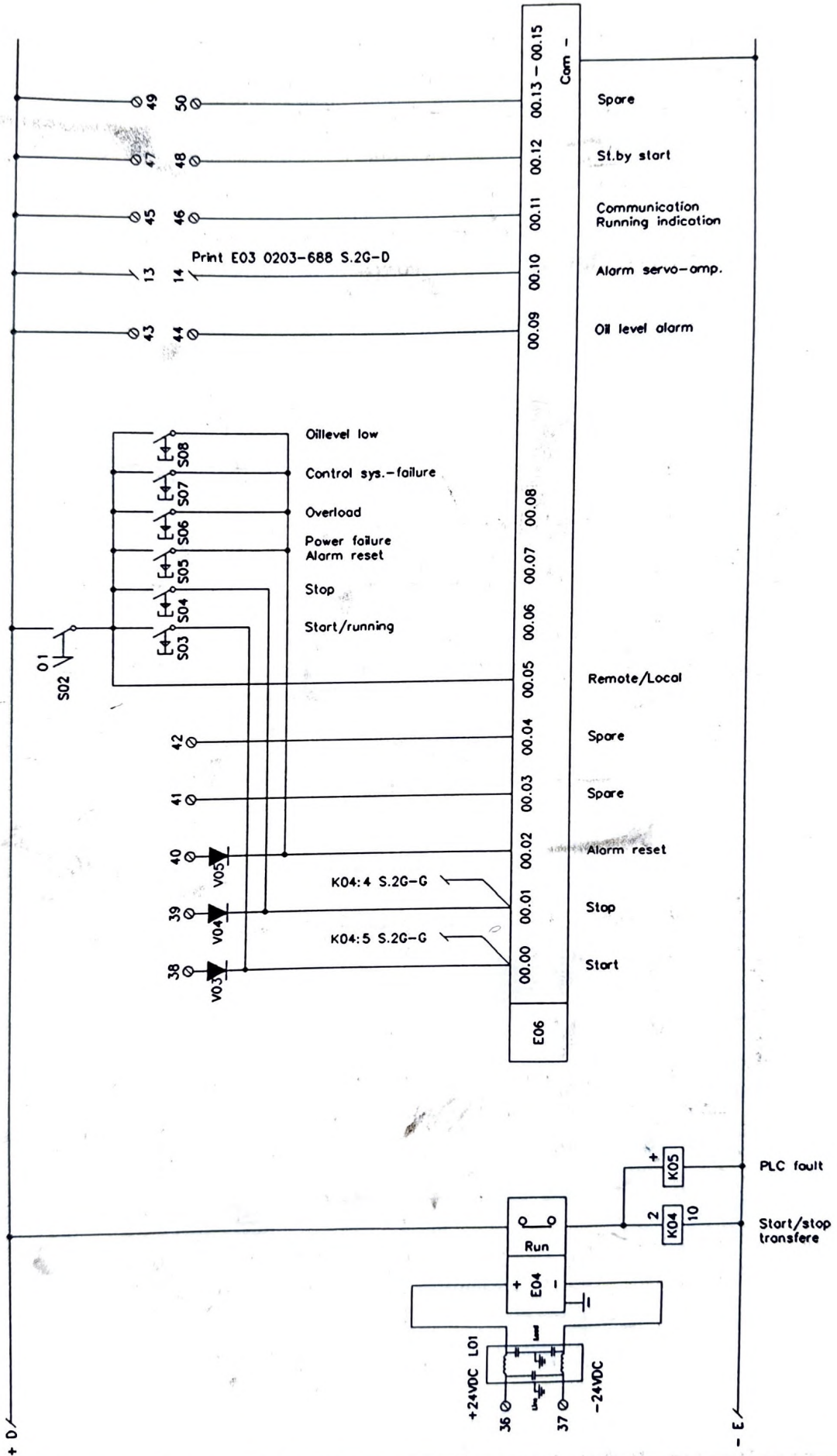

North Sea Shipyard Ltd.
DK-6950 Ringkoebing Denmark
Phone +45 97 32 38 00

Apellation
Steeringgear 2 PS (Terminals X54)

Yard No.	Unit No.	Section No.	Side No.
221	2G		E

W/MO

W.Meinertz Olesen & Co. A/S

Phone +45-97-323800

Date: 3-6-1994

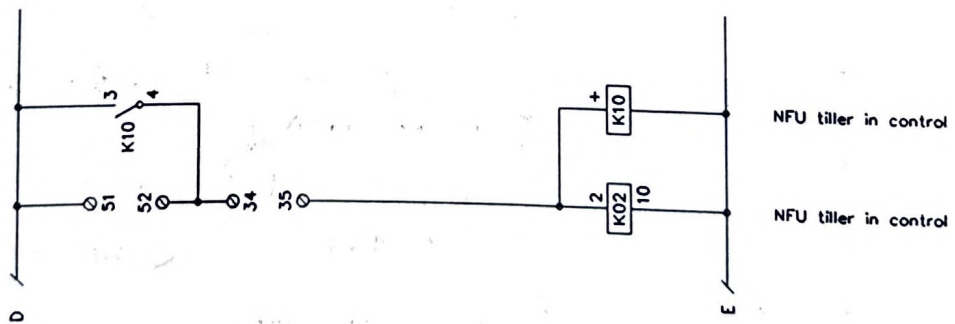

North Sea Shipyard Ltd.
 DK-6950 Ringkøbing Denmark
 Phone +45 97 32 38 00

Appellation
 Steeringgear 2 PS (Terminals X54)

Yard No.	Unit No.	Section No.	Side No.
221	2G		F

W/MO

W.Meinertz Olesen & Co. A/S

Phone +45-97-323800

Date: 3-6-1994

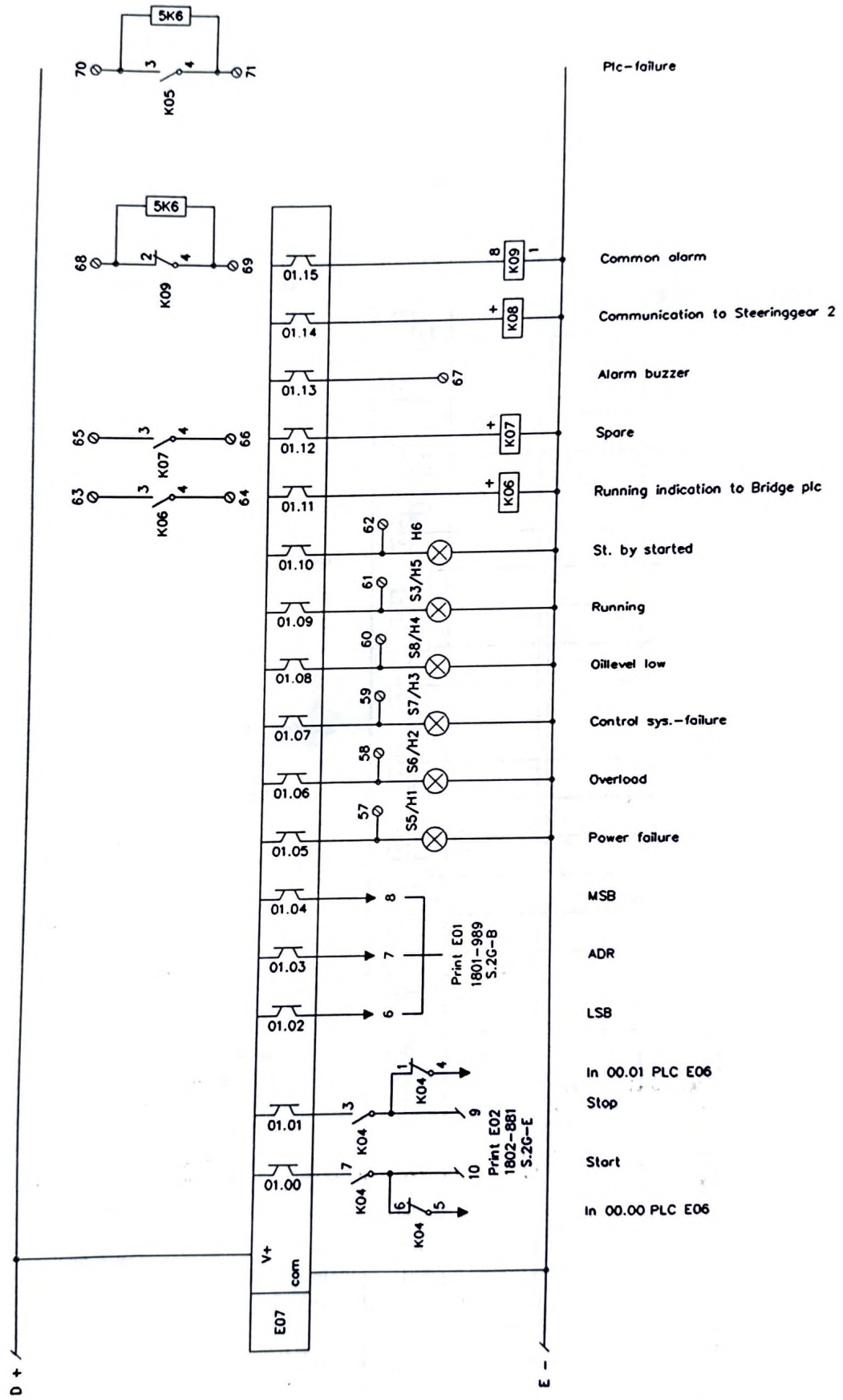

	North Sea Shipyard Ltd. DK-6950 Ringkoebing Denmark Phone +45 97 32 38 00	Appellation Steeringgear 2 PS (Terminals X54)	Yard No. 221	Unit No. 2G	Section No.	Side No. G
	W/110 W.Meinertz Olesen & Co. A/S	Phone +45-97-323800	Date: 2-5-1994			

Print E01
S.2G.B

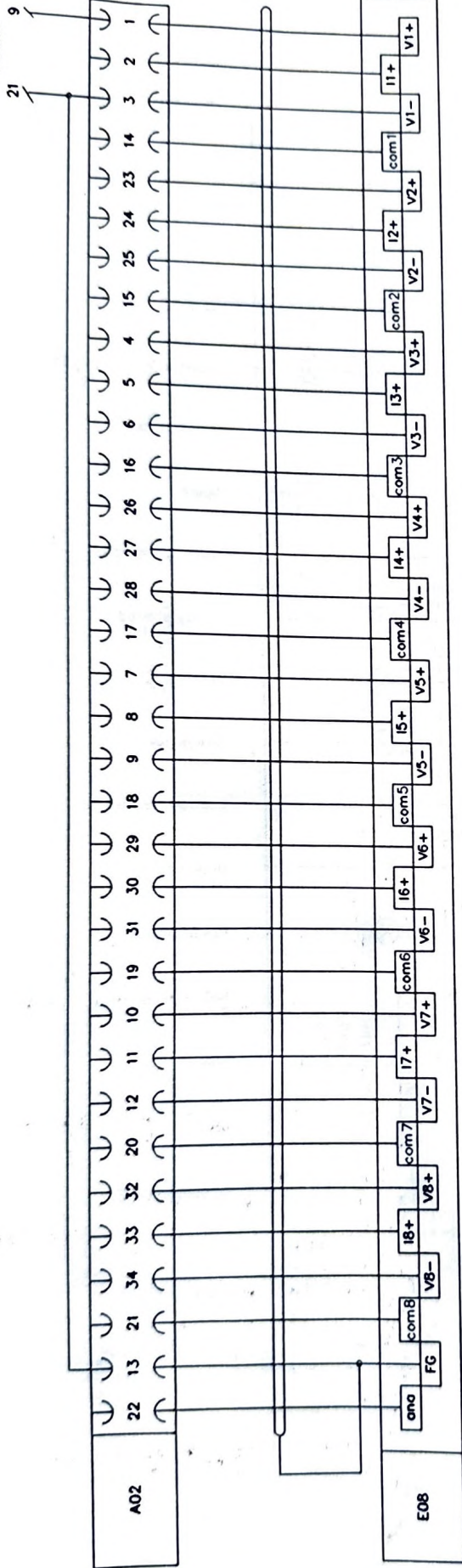

Multiplexed analog input signal
of current, internal voltage,
external voltage and oil temperature.

Unit no: 0



North Sea Shipyard Ltd.
DK-6950 Ringkøbing Denmark
Phone +45 97 32 38 00

Appellation

Steeringgear 2 PS (Terminals X54)

Yard No.

221

Unit No.

2G

Section No.

Side No.

H

W.M.O.

W.Meinertz Olesen & Co. A/S

Phone +45-97-323800

Date:

3-6-1994

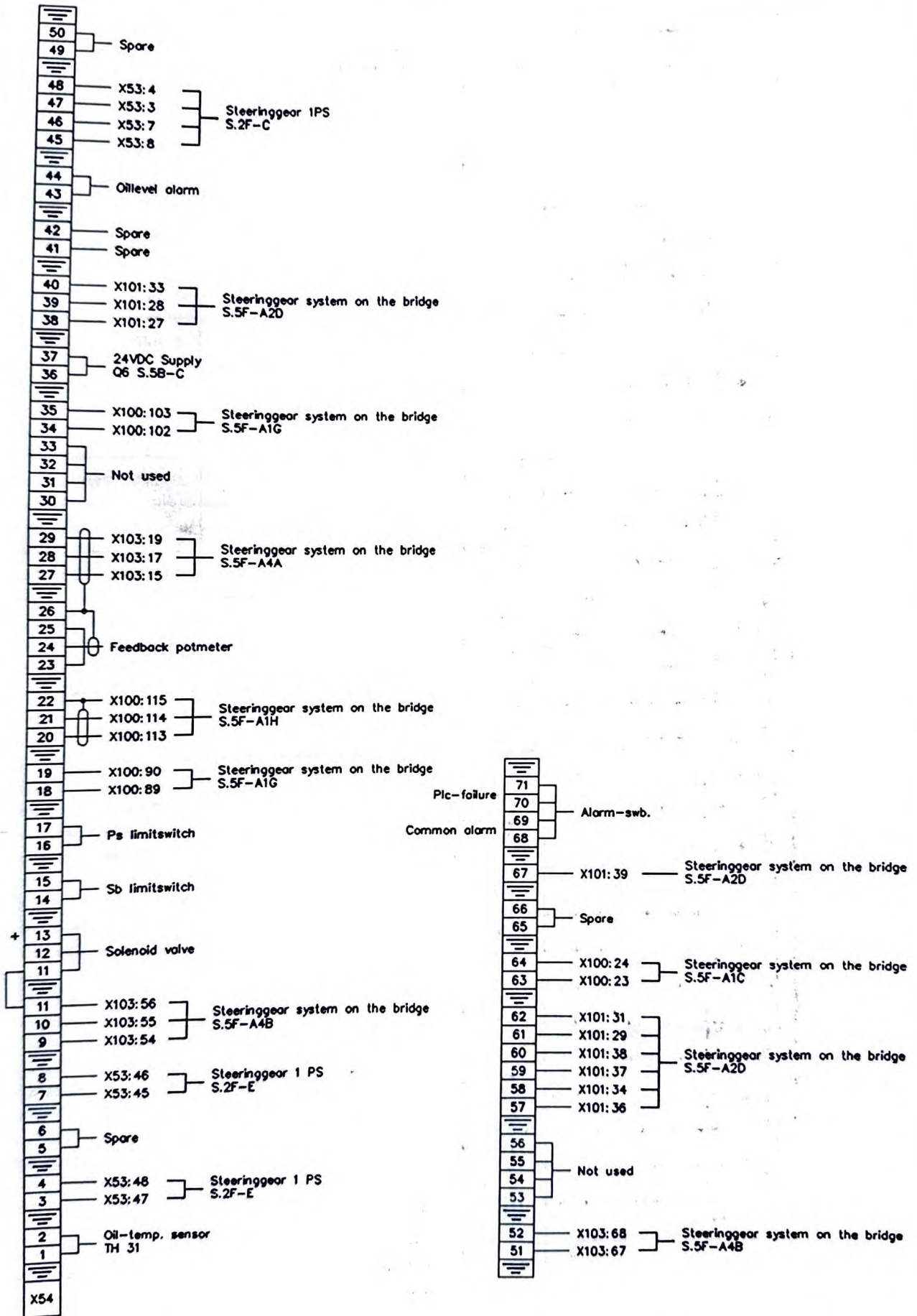

North Sea Shipyard Ltd.
 DK-6950 Ringkøbing Denmark
 Phone +45 97 32 38 00

Appellation
 Steeringgear 2 PS (Terminals X54)

Yard No.	Unit No.	Section No.	Side No.
221	2C		I

W/MO

W.Meinertz, Olesen & Co. A/S

Phone +45-97-323800

Date: 19-5-1994

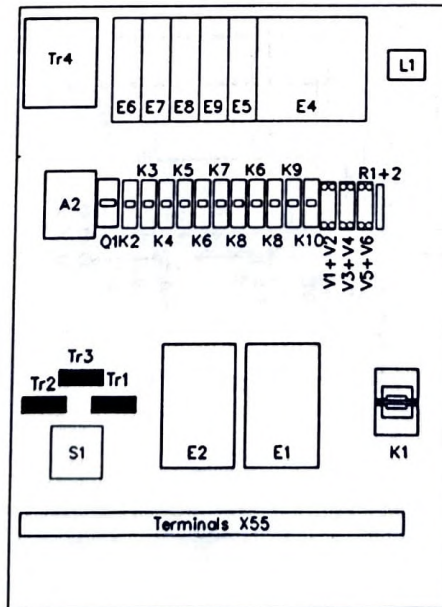
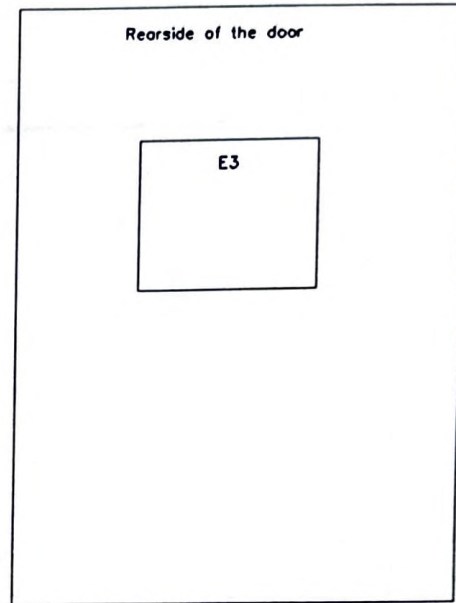
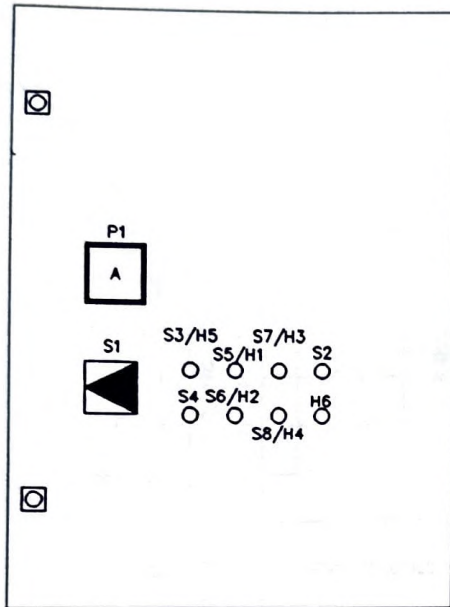

North Sea Shipyard Ltd.
DK-6950 Ringkoebing Denmark
Phone +45 97 32 38 00

Appellation

Steeringgear 1 SB (Terminals X55)

Yard No.

221

Unit No.

2H

Section No.

Side No.

A

WMO

W.Meinertz Olesen & Co. A/S

Phone +45-97-323800

Date: 1-6-1994

Emergency switchboard
F7 S.2K-C3D
3x6mm MGG 1000V

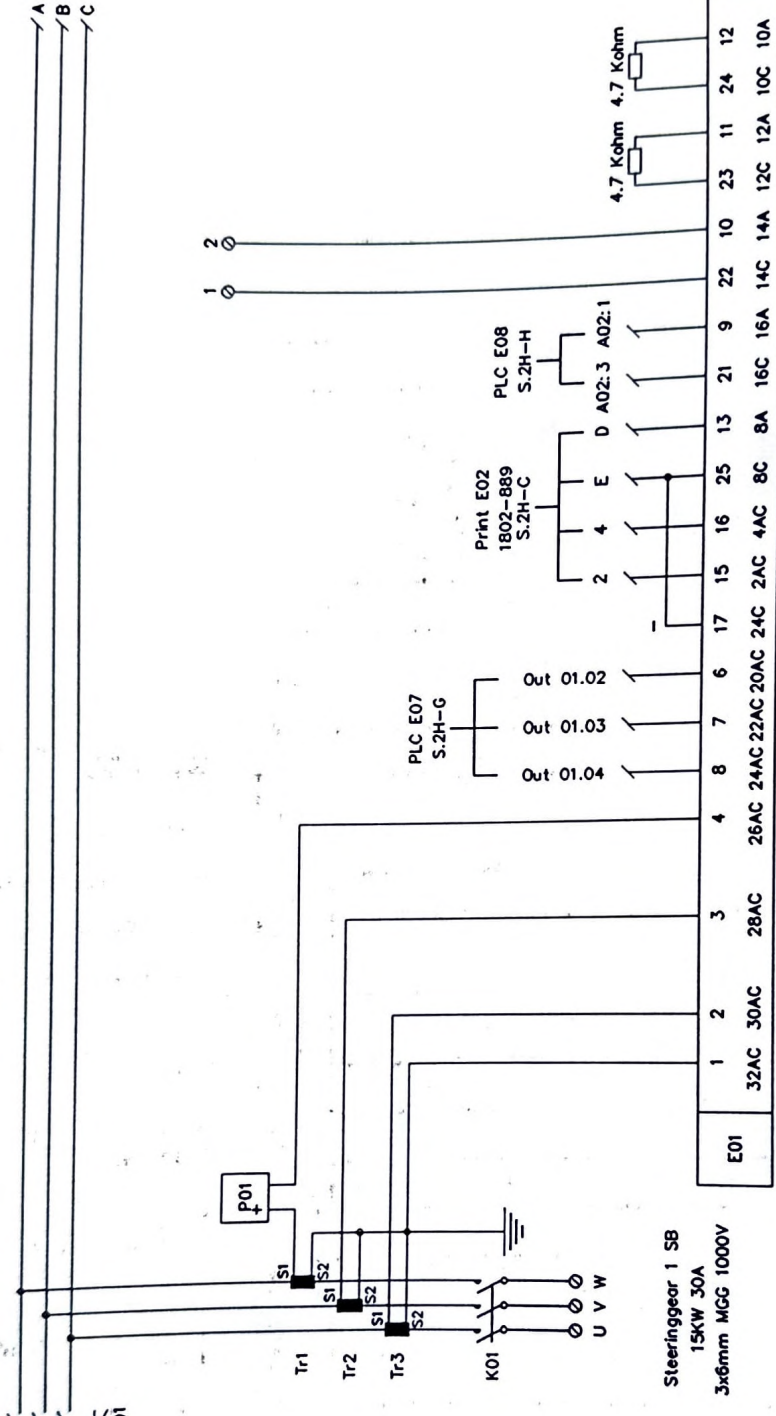

Steeringgear 1 SB
15KW 30A
3x6mm MGG 1000V

Multiplexer



North Sea Shipyard Ltd.
DK-6950 Ringkøbing Denmark
Phone +45 97 32 38 00

Apellation
Steeringgear 1 SB (Terminals X55)

Yard No.	Unit No.	Section No.	Side No.
221	2H		B

W/MO

W.Meinertz Olesen & Co. A/S

Phone +45-97-323800

Date: 1-6-1994

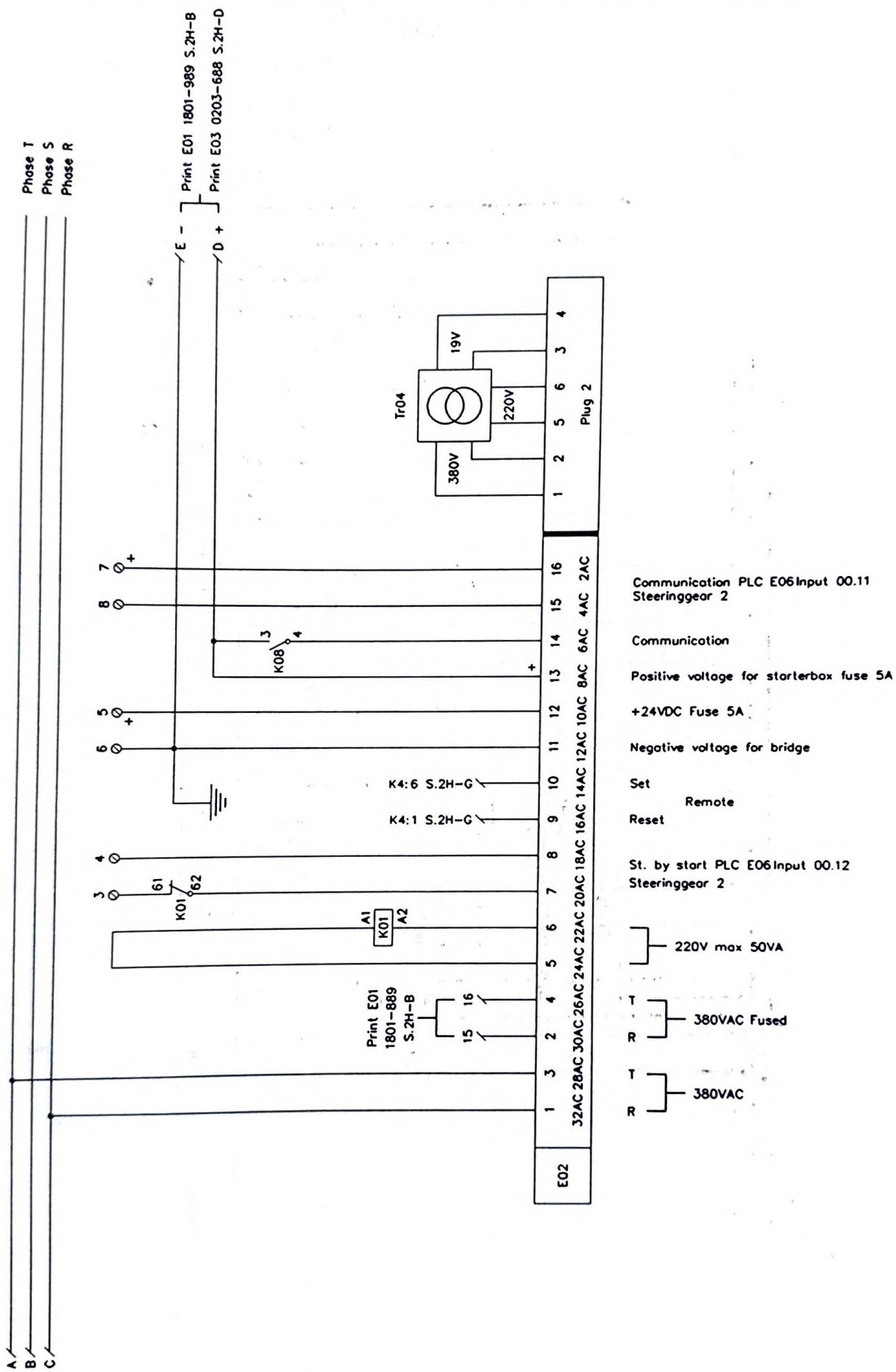

	North Sea Shipyard Ltd. DK-6950 Ringkoebing Denmark Phone +45 97 32 38 00	Apellation	Yard No.	Unit No.	Section No.	Side No.
		Steeringgear 1 SB (Terminals X55)	221	2H		C
WMO	W.Meinertz Olesen & Co. A/S	Phone +45-97-323800	Date:	3-6-1994		

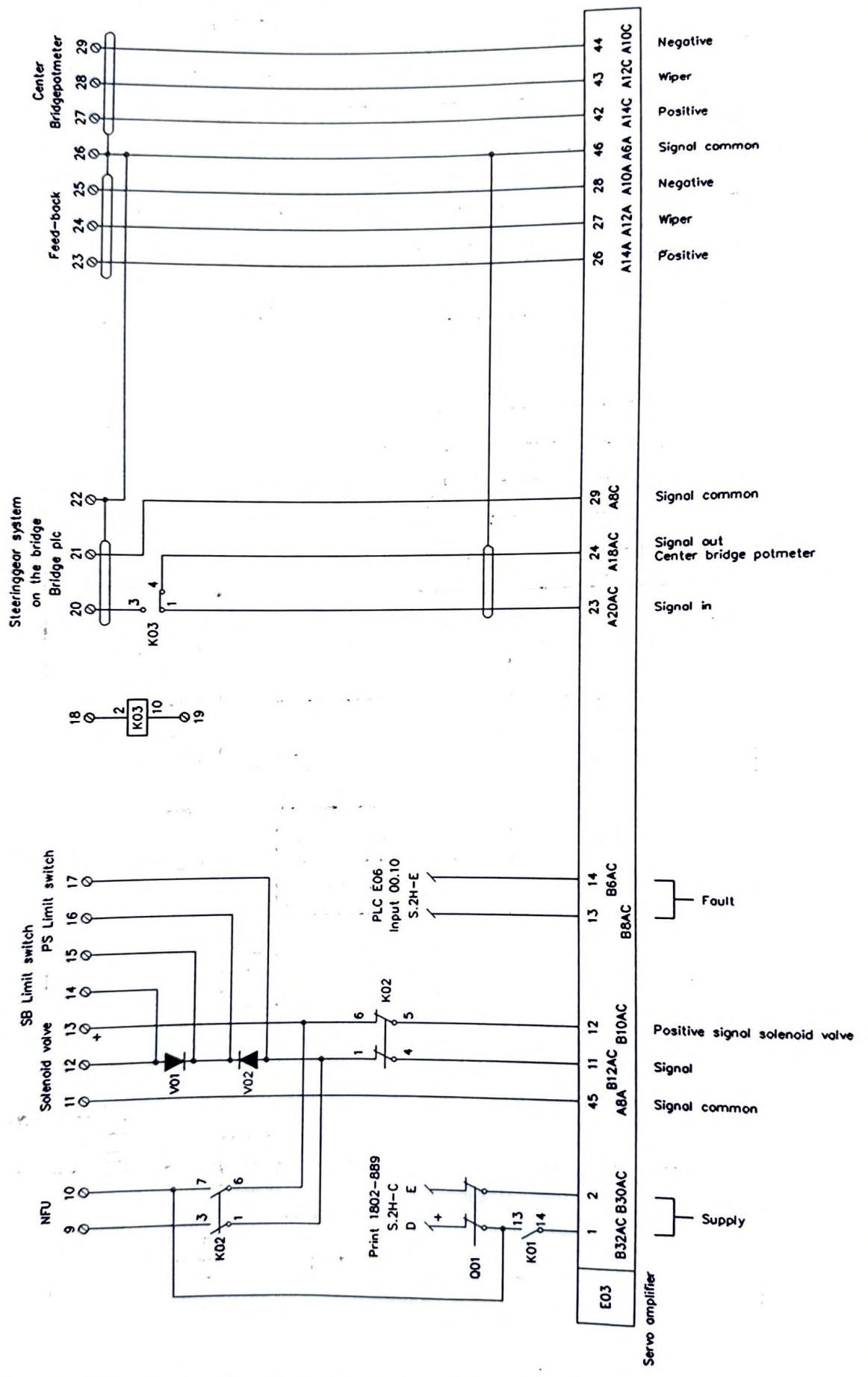

	North Sea Shipyard Ltd. DK-6950 Ringkoebing Denmark Phone +45 97 32 38 00	Apellation			
		Steeringgear 1 SB (Terminals X55)			
WMIO	W.Meinertz Olesen & Co. A/S Phone +45-97-323800	Yard No. 221	Unit No. 2H	Section No.	Side No. D
		Date:		3-6-1994	

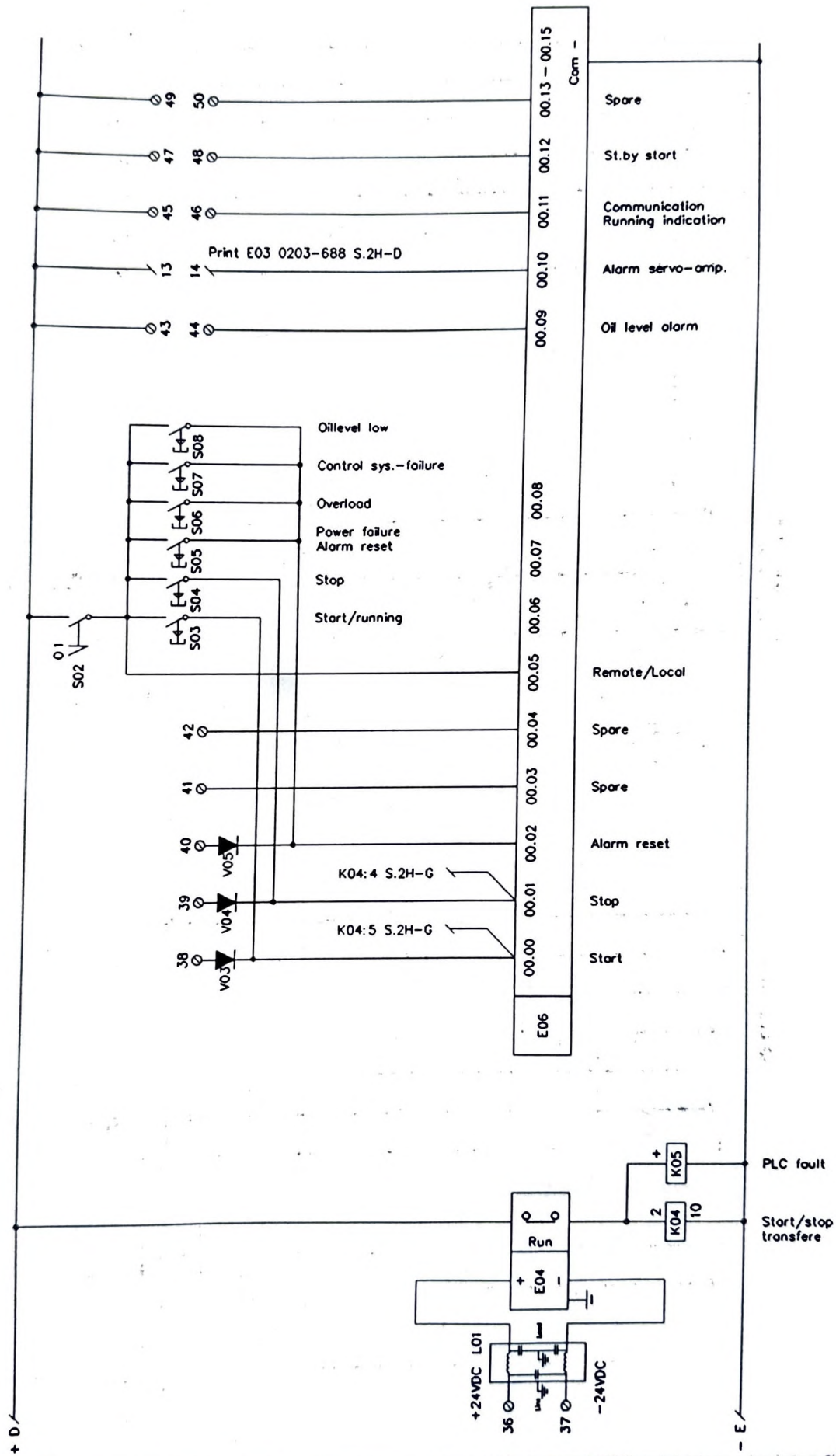

	North Sea Shipyard Ltd. DK-6950 Ringkøbing Denmark Phone +45 97 32 38 00	Apellation	Yard No.	Unit No.	Section No.	Side No.
		Steeringgear 1 SB (Terminals X55)	221	2H		E
W110	W.Meinertz Olesen & Co. A/S	Phone +45-97-323800	Date:	3-6-1994		

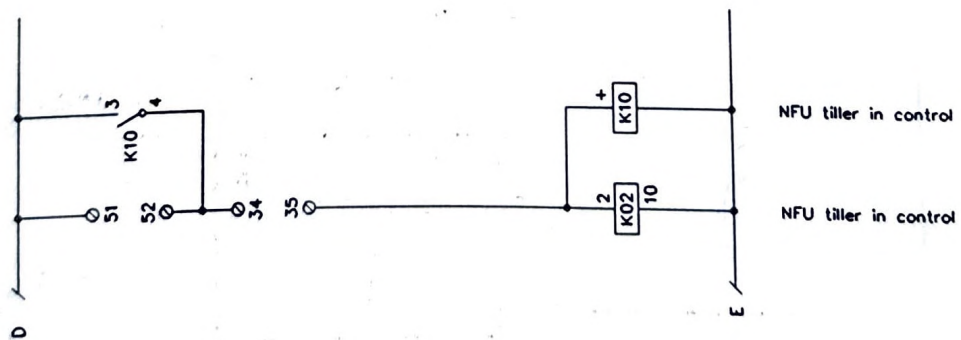

North Sea Shipyard Ltd.
 DK-6950 Ringkøbing Denmark
 Phone +45 97 32 38 00

Appellation

Steeringgear 1 SB (Terminals X55)

Yard No.	Unit No.	Section No.	Side No.
221	2H		F

W/110

W.Meinertz-Olesen & Co. A/S

Phone +45-97-323800

Date: 3-6-1994

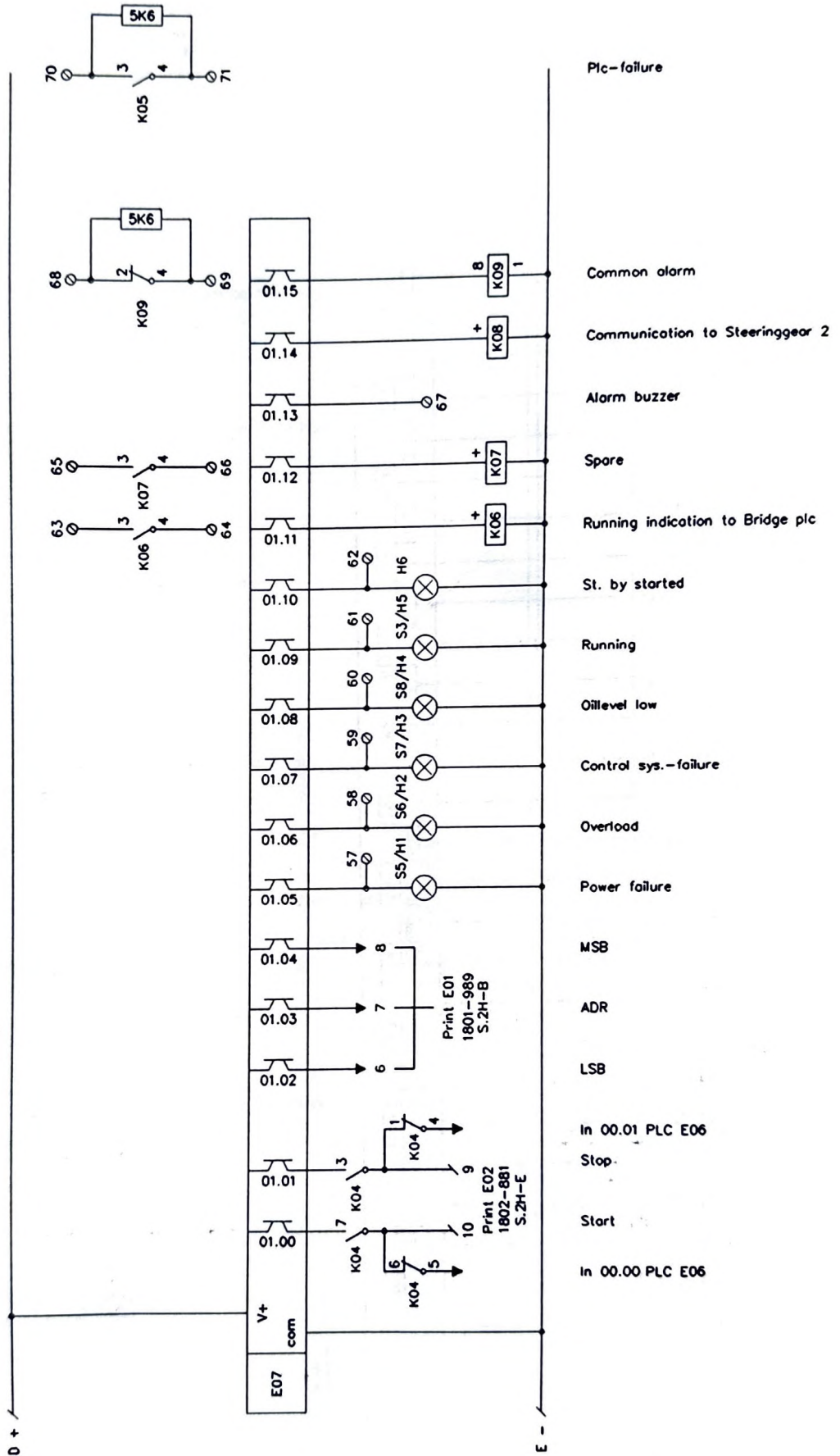

	North Sea Shipyard Ltd.	Apellation	Yard No.	Unit No.	Section No.	Side No.
	DK-6950 Ringkøbing Denmark Phone +45 97 32 38 00	Steeringgear 1 SB (Terminals X55)	221	2H		G
W/MO	W.Meinertz Olesen & Co. A/S	Phone +45-97-323800	Date:	2-5-1994		

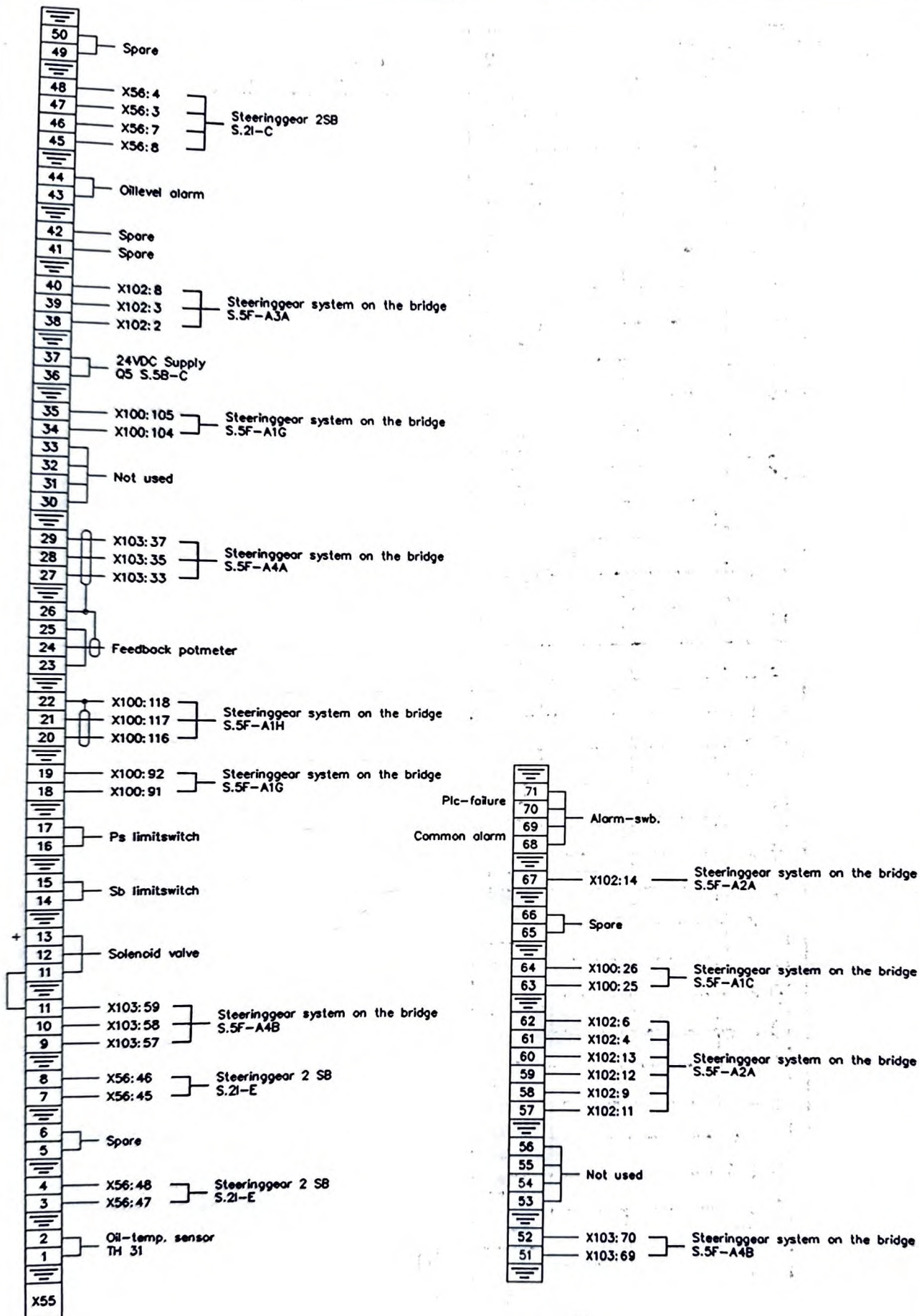

North Sea Shipyard Ltd.
 DK-6950 Ringkoebing Denmark
 Phone +45 97 32 38 00

Appellation
 Steeringgear 1 SB (Terminals X55)

Yard No.	Unit No.	Section No.	Side No.
221	2H		I

W/MO

W.Meinertz Olesen & Co. A/S

Phone +45-97-323800

Date: 19-5-1994

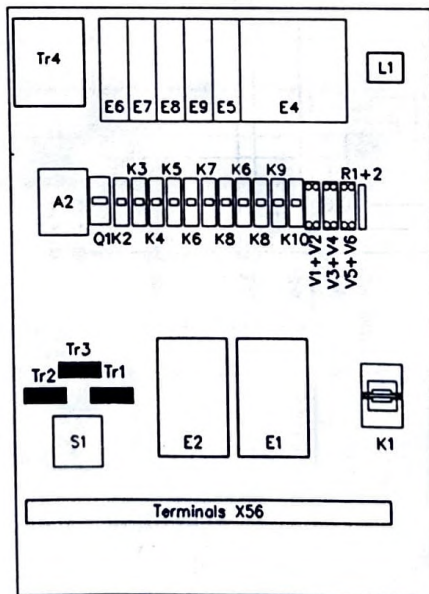
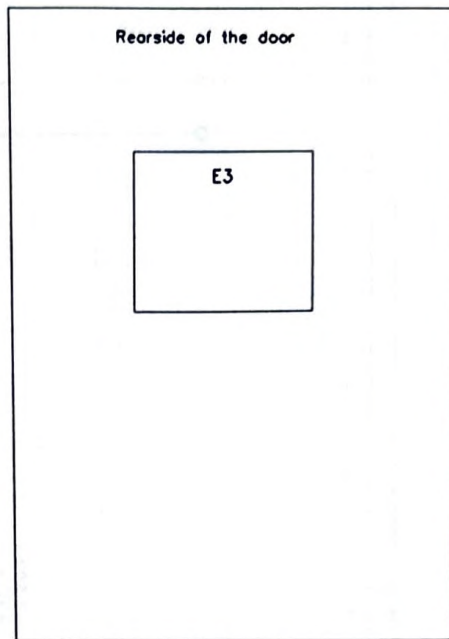
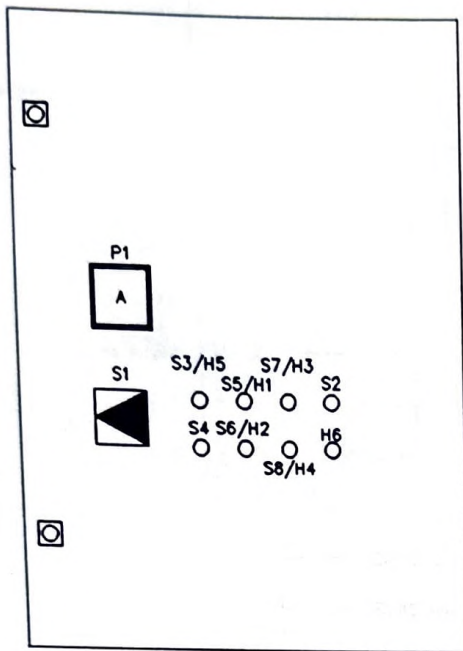

NS	North Sea Shipyard Ltd.	Apellation	Yard No.	Unit No.	Section No.	Side No.
	DK-6950 Ringkoebing Denmark Phone +45 97 32 38 00	Steeringgear 2 SB (Terminals X56)	221	21		A
WMO	W.Meinertz Olesen & Co. A/S		Phone +45-97-323800	Date:	1-6-1994	

220/380V switchboard
F6 S.2B-C1A
3x6mm MGG 1000V

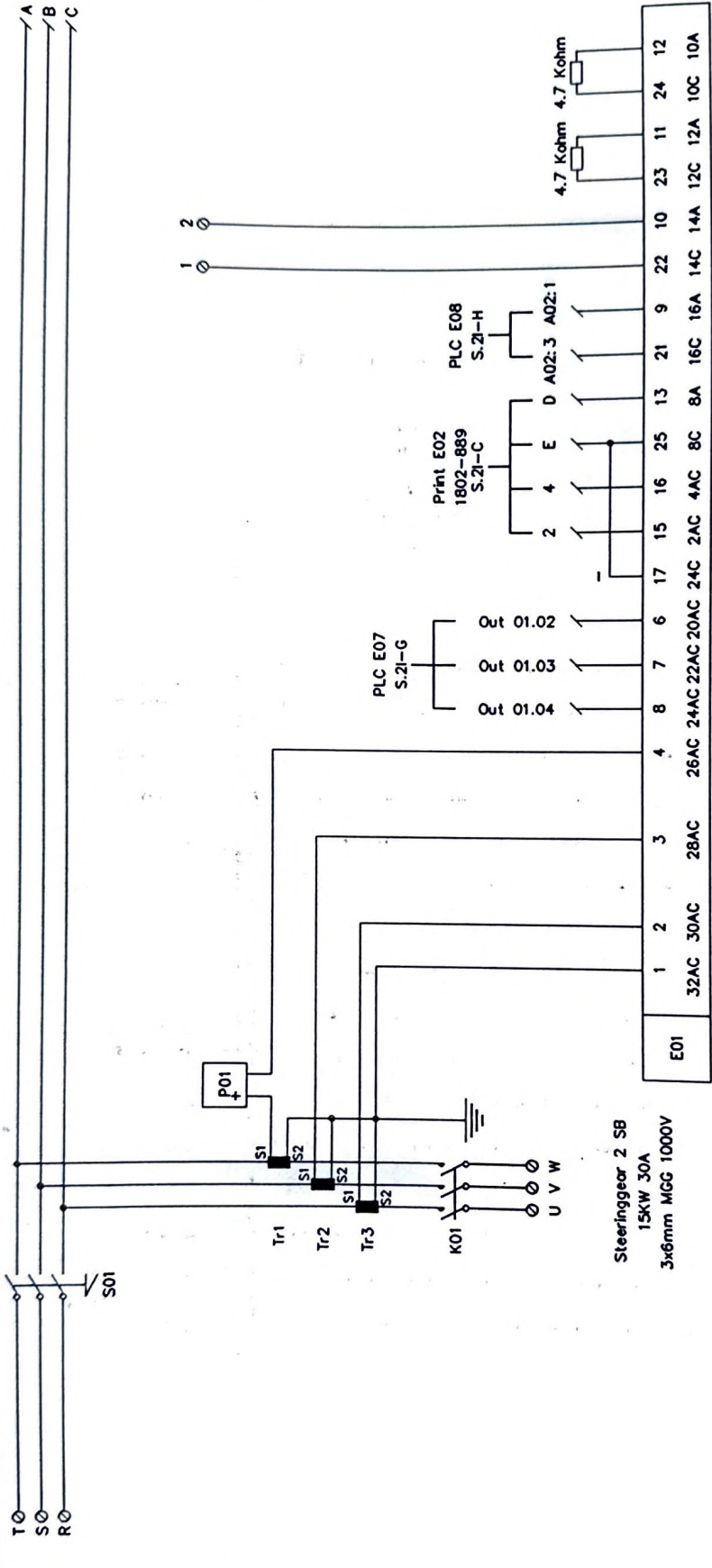

Steeringgear 2 SB
15KW 30A
3x6mm MGG 1000V



North Sea Shipyard Ltd.
DK-6950 Ringkoebing Denmark
Phone +45 97 32 38 00

Apellation
Steeringgear 2 SB (Terminals X56)

Yard No.	Unit No.	Section No.	Side No.
221	2i		B

W.M.O. W.Meinertz, Olesen & Co. A/S

Phone +45-97-323800

Date: 1-6-1994

Phase T
Phase S
Phase R

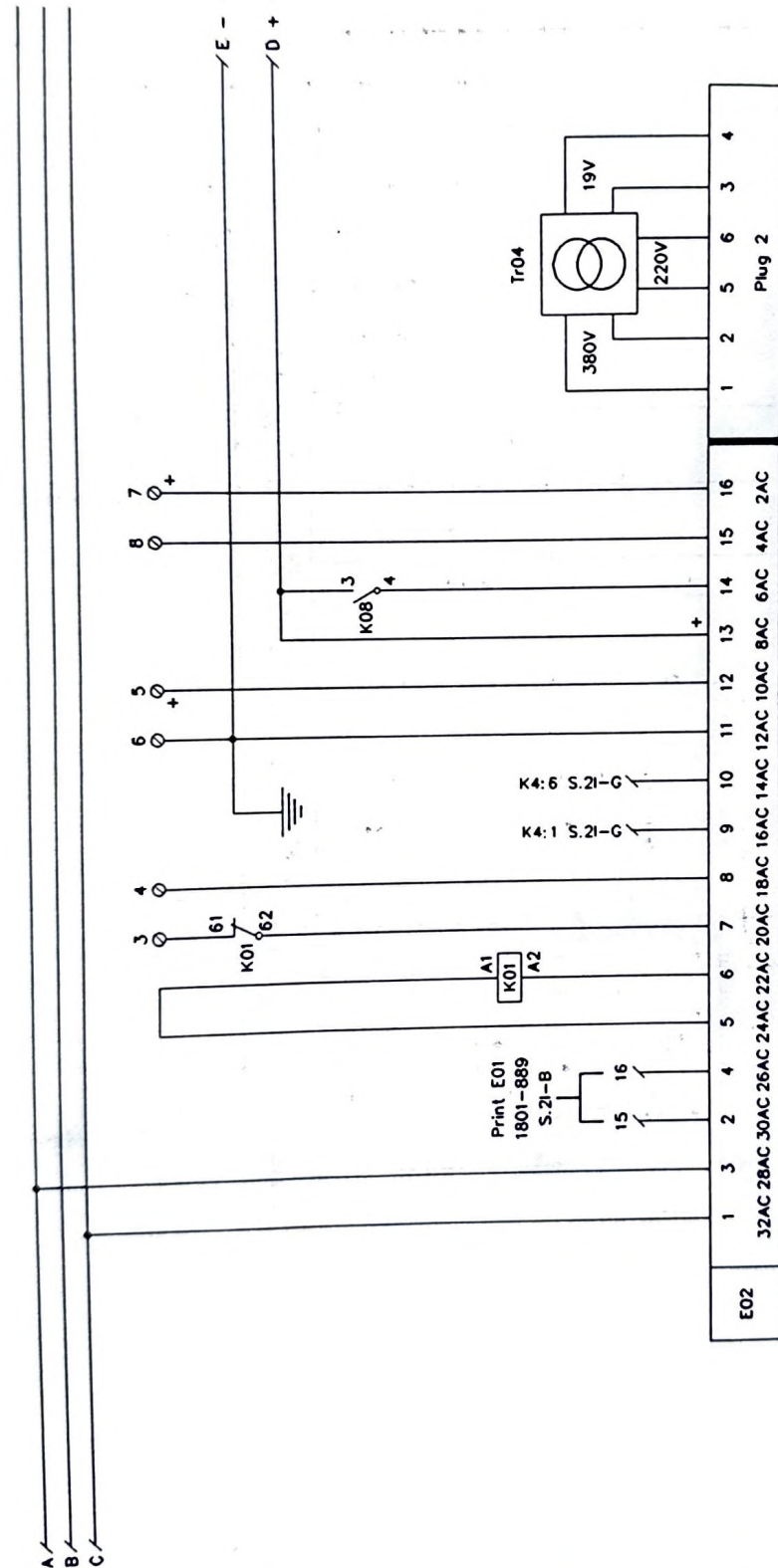

Communication PLC E06 Input 00.11
Steeringgear 1

Communication

Positive voltage for starterbox fuse 5A

+24VDC Fuse 5A

Negative voltage for bridge

Set

Remote

Reset

St. by start PLC E06 Input 00.12
Steeringgear 1

220V max 50VA

380VAC Fused

380VAC



North Sea Shipyard Ltd.
DK-6950 Ringkoebing Denmark
Phone +45 97 32 38 00

Apellation

Steeringgear 2 SB (Terminals X56)

Yard No.

221

Unit No.

2I

Section No.

Side No.

C

W/MC

W.Meinertz Olesen & Co. A/S

Phone +45-97-323800

Date: 3-6-1994

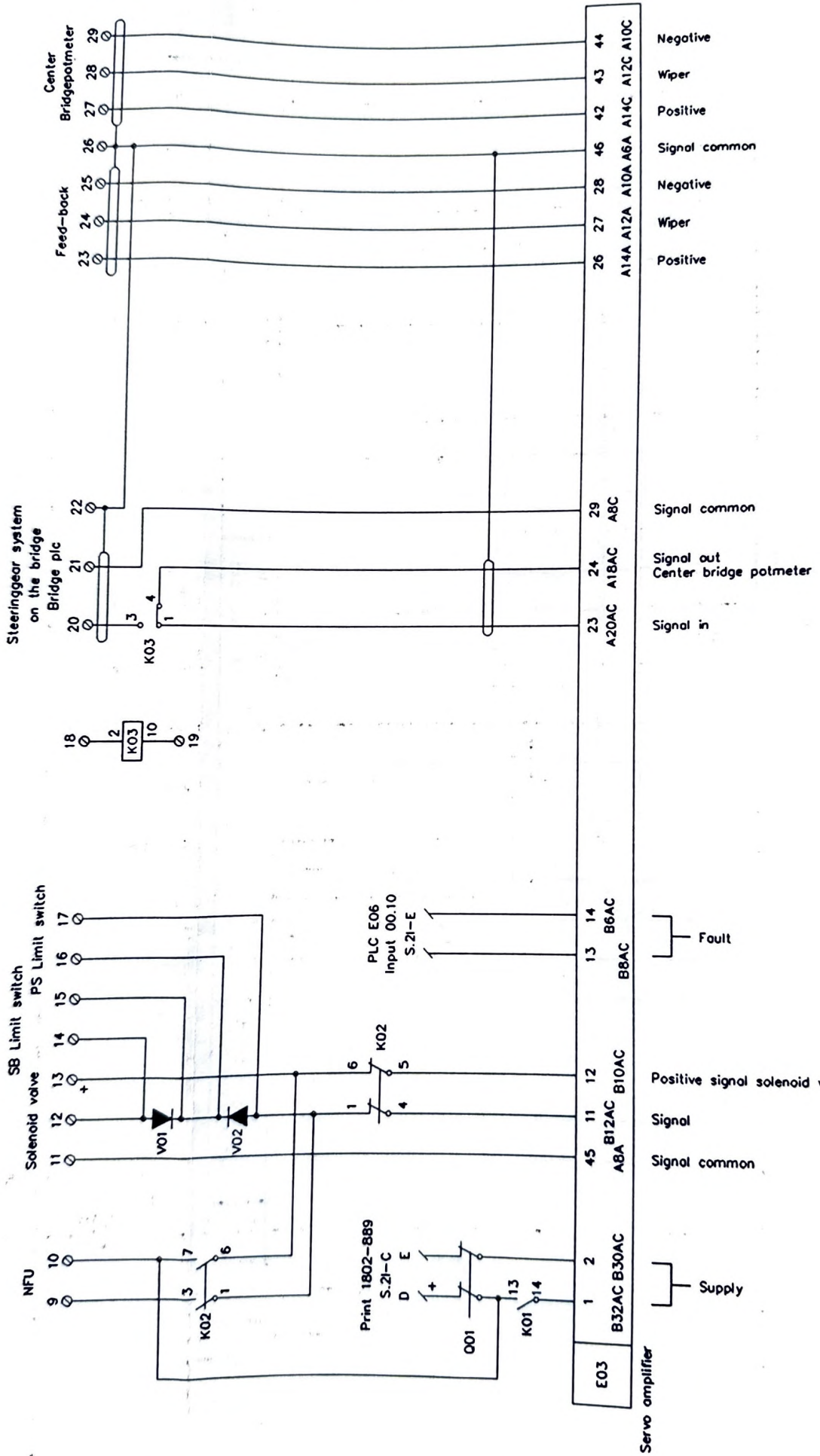

North Sea Shipyard Ltd.
 DK-6950 Ringkøbing Denmark
 Phone +45 97 32 38 00

Apellation
 Steeringgear 2 SB (Terminals X56)

Yard No.	Unit No.	Section No.	Side No.
221	21		D

Meinertz Olesen & Co. A/S

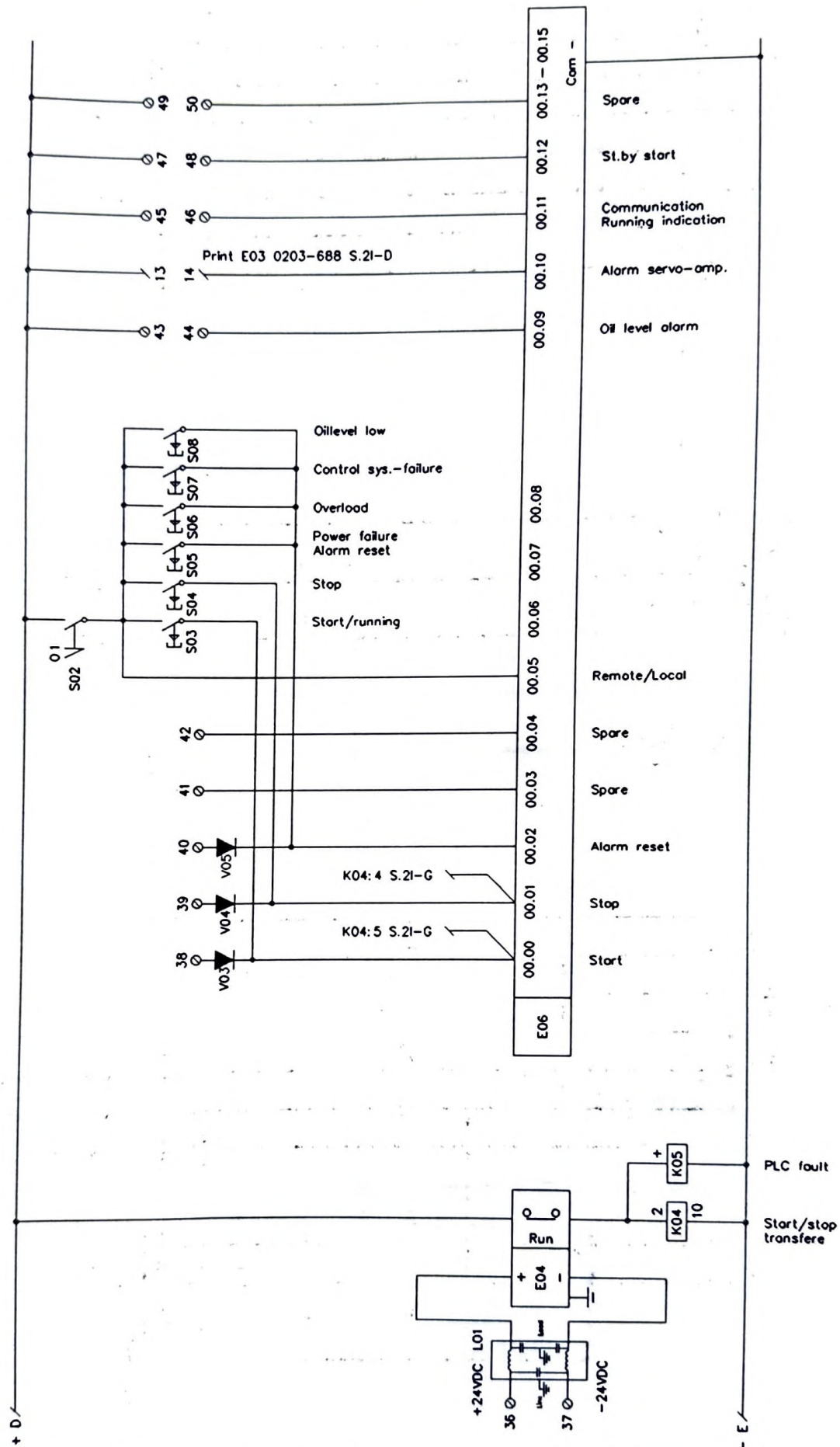

North Sea Shipyard Ltd.
 DK-6950 Ringkøbing Denmark
 Phone +45 97 32 38 00

Appellation
 Steeringgear 2 SB (Terminals X56)

Yard No.	Unit No.	Section No.	Side No.
221	21		E

W/MO

W.Meinertz Olesen & Co. A/S

Phone +45-97-323800

Date: 3-6-1994

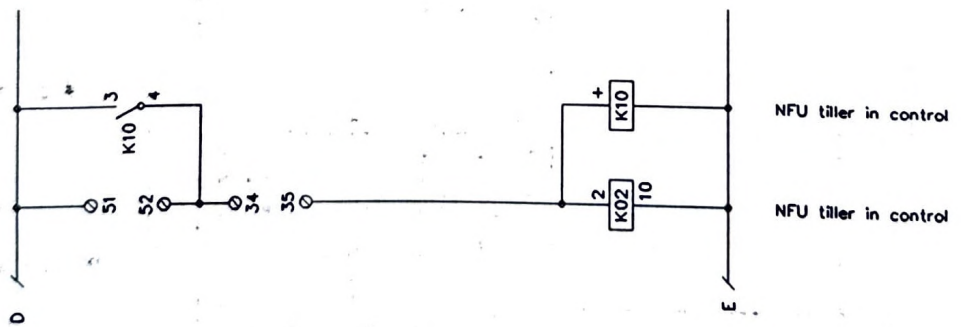

North Sea Shipyard Ltd.

DK-6950 Ringkøbing Denmark
Phone +45 97 32 38 00

Appellation

Steeringgear 2 SB (Terminals X56)

Yard
No.

221

Unit
No.

21

Section
No.

Side
No.

F

WMO

W.Meinertz Olesen & Co. A/S

Phone +45-97-323800

Date:

3-6-1994

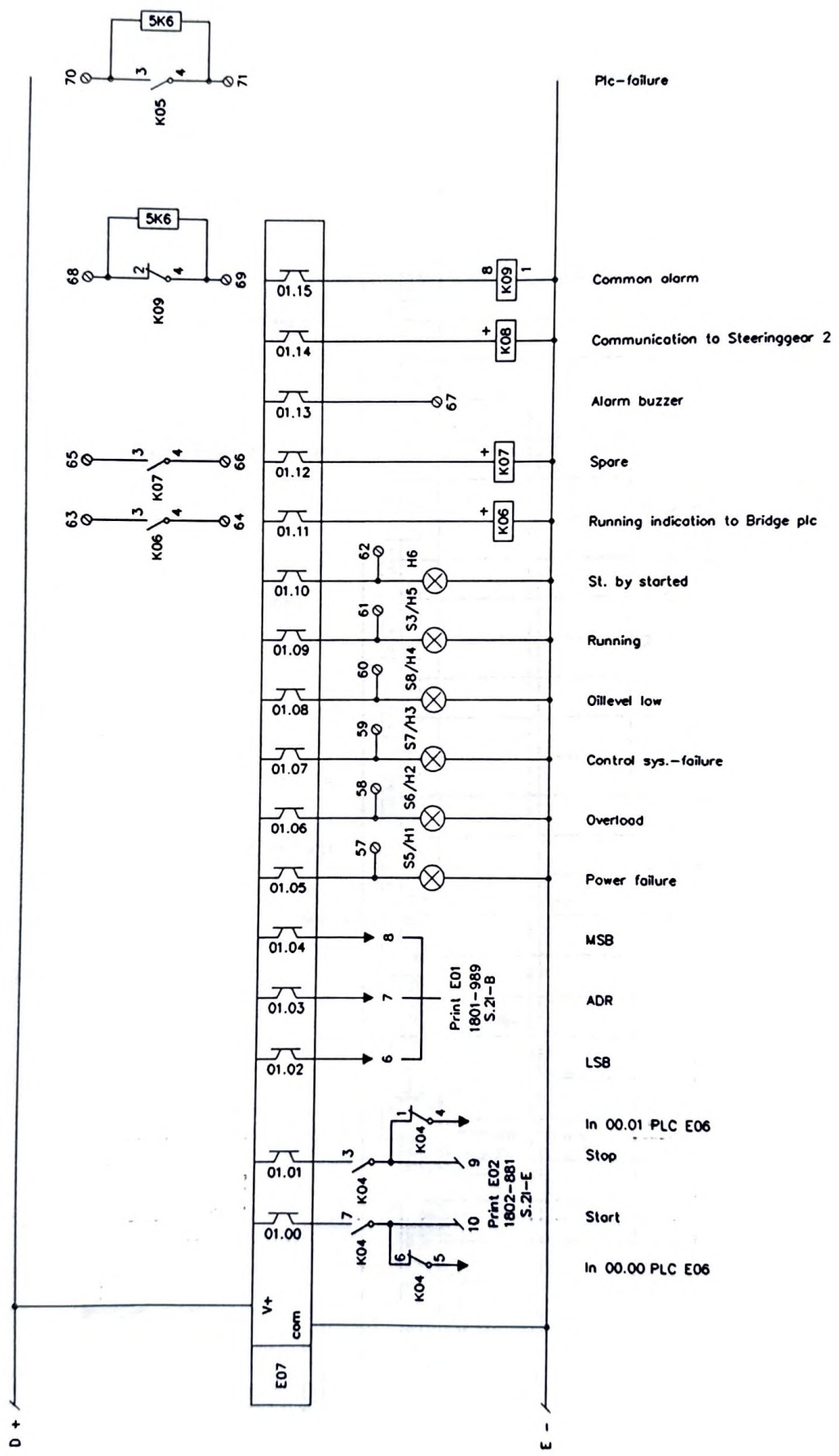

N	North Sea Shipyard Ltd. DK-6950 Ringkøbing Denmark Phone +45 97 32 38 00	Appellation	Yard No.	Unit No.	Section No.	Side No.
		Steeringgear 2 SB (Terminals X56)	221	21		G
W/MO	W.Meinertz Olesen & Co. A/S	Phone +45-97-323800	Date:		2-5-1994	